

PC QUICK-FIT MALE TERMINALS

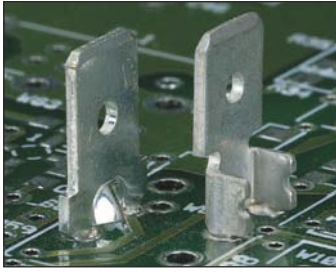

Underwriters Laboratories, Inc.
Recognized Component Program —
UL File Number E201546



UL file number E201546 has been assigned to Keystone Electronics' "Quick-Fit" terminals (Refer to pages 52-54) indicating recognition by Underwriters Laboratories Inc. that they are in compliance with their component program.

Underwriters Laboratories Inc. component program assures that "Quick-Fit" terminals meet the dimensional and performance requirements of the National Electrical Manufacturers Association specification number NEMA2-1982-(1988) and UL310.



.110 (2.8) TAB

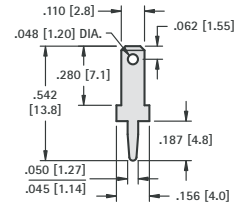

CAT. NO.	MATERIAL	MTG. HOLE
1267	.020 (.50) Brass, Tin Plate	.046 (1.2) Dia.
1211	.032 (.80) Brass, Tin Plate	.052 (1.3) Dia.

.110 (2.8) TAB

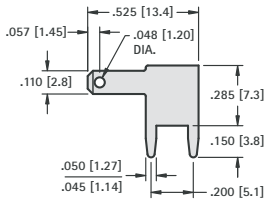

.110 (2.8) & .187 (4.8) TAB

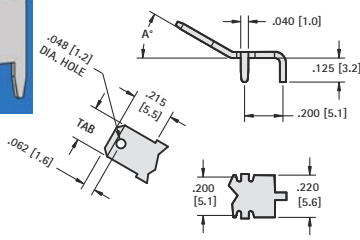

.187 (4.8) TAB

STURDI-MOUNT

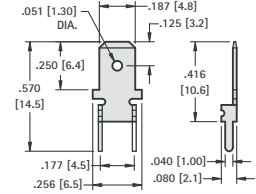

Material: .020 (.50) Brass, Tin Plate
Mtg Holes: .046 (1.2) Dia.

.110 (2.8) TAB	A ANGLE	.187(4.8) TAB
4915*	0°	4918*
4916*	30°	4919*
4917*	60°	4920*

CAT. NO.	MATERIAL	MTG. HOLES
4903	.020 (.50) Brass, Tin Plate	.046 (1.2) Dia.
4906	.032 (.80) Brass, Tin Plate	.052 (1.3) Dia.

CAT. NO.	MATERIAL	MTG. HOLES
4900	.020 (.50) Brass, Tin Plate	.043 (1.1) Dia.

.187 (4.8) TAB

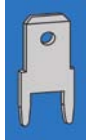
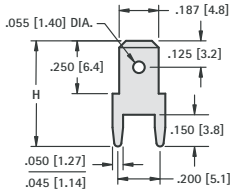

.187 (4.8) TAB

STURDI-MOUNT

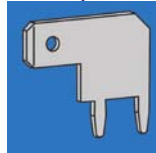
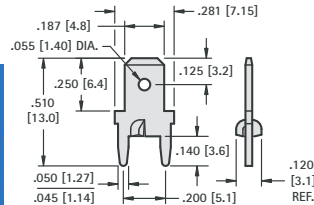

.187 (4.8) TAB

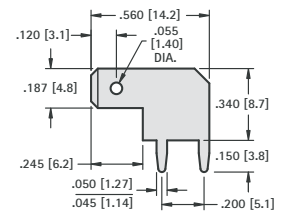

Material: Brass, Tin Plate

CAT. NO.	H	MATL THICK	MTG. HOLES
1285	.500 (12.7)	.020 (.50)	.046 (1.2) Dia.
1212	.500 (12.7)	.032 (.80)	.052 (1.3) Dia.
1216	.860 (21.8)	.032 (.80)	.052 (1.3) Dia.

CAT. NO.	MATERIAL	MTG. HOLES
1285-ST	.020 (.50) Brass, Tin Plate	.046 (1.2) Dia.
1212-ST	.032 (.80) Brass, Tin Plate	.052 (1.3) Dia.

CAT. NO.	MATERIAL	MTG. HOLES
4904	.020 (.50) Brass, Tin Plate	.046 (1.2) Dia.
4907	.032 (.80) Brass, Tin Plate	.052 (1.3) Dia.

.205 (5.2) TAB

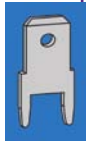
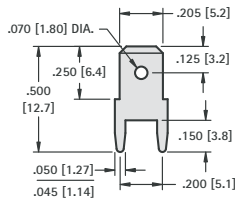

.205 (5.2) TAB

STURDI-MOUNT

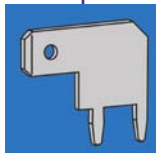
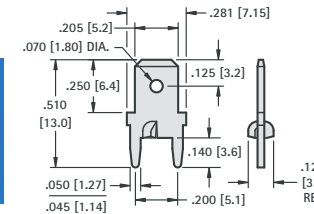

.205 (5.2) TAB

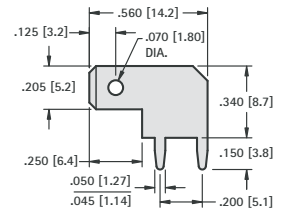

CAT. NO.	MATERIAL	MTG. HOLES
1286	.020 (.50) Brass, Tin Plate	.046 (1.2) Dia.
1213	.032 (.80) Brass, Tin Plate	.052 (1.3) Dia.

CAT. NO.	MATERIAL	MTG. HOLES
1286-ST	.020 (.50) Brass, Tin Plate	.046 (1.2) Dia.
1213-ST	.032 (.80) Brass, Tin Plate	.052 (1.3) Dia.

CAT. NO.	MATERIAL	MTG. HOLES
4905*	.020 (.50) Brass, Tin Plate	.046 (1.2) Dia.
4909*	.032 (.80) Brass, Tin Plate	.052 (1.3) Dia.

* Not UL Recognized

PC QUICK-FIT TERMINALS



.250 (6.4) TAB

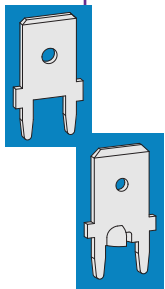
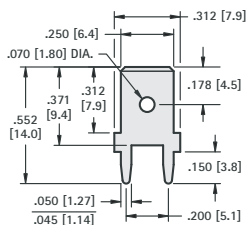

CAT. NO.	MATERIAL	MTG. HOLES
1287	.032 (.80) Brass, Tin Plate	.052 (1.3) Dia.

.250 (6.4) TAB

STURDI-MOUNT

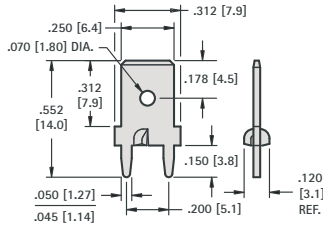

CAT. NO.	MATERIAL	MTG. HOLES
1287-ST	.032 (.80) Brass, Tin Plate	.052 (1.3) Dia.

DUAL .110 (2.8)/.250 (6.4) TAB

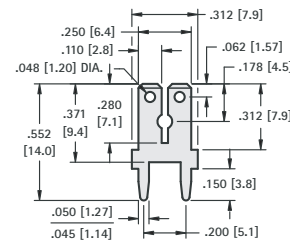

CAT. NO.	MATERIAL	MTG. HOLES
1282	.032 (.80) Brass, Tin Plate	.052 (1.3) Dia.

.250 (6.4) TAB

STURDI-MOUNT

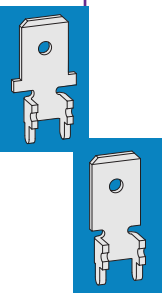
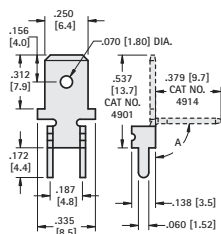

MATERIAL: .032 (.80) Brass, Matte Tin Plate

CAT. NO.	ANGLE A	MTG. HOLES
4901	0°	.067 (1.7) Dia.
4914	90°	.067 (1.7) Dia.

.250 (6.4) TAB

STURDI-MOUNT

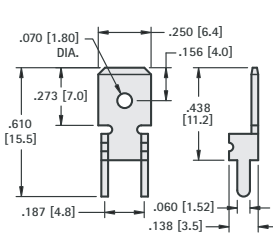

CAT. NO.	MATERIAL	MTG. HOLES
4902	.032 (.80) Brass, Tin Plate	.067 (1.7) Dia.

.250 (6.4) TAB

STURDI-MOUNT

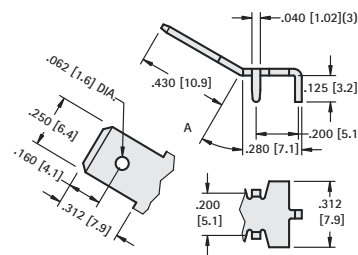

MATERIAL: .032 (.80) Brass, Matte Tin Plate

CAT. NO.	ANGLE A	MTG. HOLES
4910	0°	.052 (1.3) Dia.
4908	30°	.052 (1.3) Dia.
4912	60°	.052 (1.3) Dia.

.250 (6.4) TAB

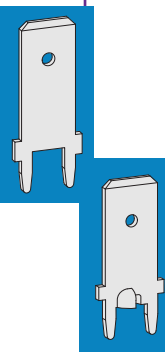
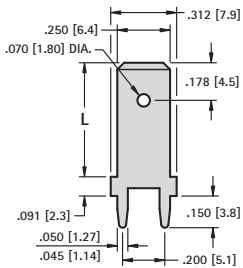

MATERIAL: .032 (.80) Brass, Matte Tin Plate

CAT. NO.	"L"	MTG. HOLES
1289	.540 (13.7)	.067 (1.7) Dia.
1292	.710 (18.0)	.067 (1.7) Dia.

.250 (6.4) TAB

STURDI-MOUNT

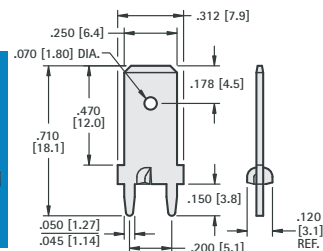

CAT. NO.	MATERIAL	MTG. HOLES
1289-ST	.032 (.80) Brass, Tin Plate	.052 (1.3) Dia.

.250 (6.4) TAB

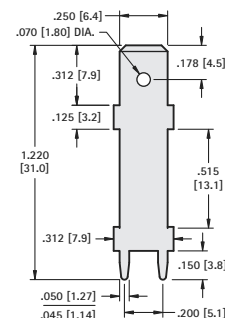

CAT. NO.	MATERIAL	MTG. HOLES
1281	.032 (.80) Brass, Tin Plate	.052 (1.3) Dia.

.250 (6.4) TAB

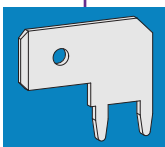
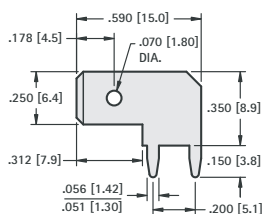

CAT. NO.	MATERIAL	MTG. HOLES
4966	.032 (.80) Brass, Tin Plate	.056 (1.4) Dia.

.250 (6.4) TAB

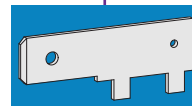
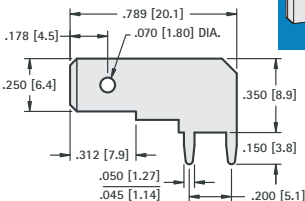

CAT. NO.	MATERIAL	MTG. HOLES
1266	.032 (.80) Brass, Tin Plate	.052 (1.3) Dia.

.250 (6.4) TAB

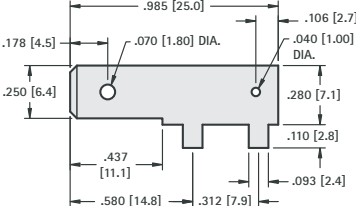

CAT. NO.	MATERIAL	MTG. HOLES
1265	.032 (.80) Brass, Tin Plate	.106 (2.7) Dia.