

MIDGET, SPF (5AG) FUSE HOLDER

- Designed for SPF (Solar Protection Fuse)
- Optional cover will protect and insulate fuse
- Flame resistant

SPECIFICATIONS

Base & Cover: Nylon, UL Rated 94V-0

Clips: .030 (.76) Brass, Matte Tin Plate

Rated: 30 Amps

Operating Temp. Range: -58°F to +292°F (-50°C to +145°C)



3576 (THM)

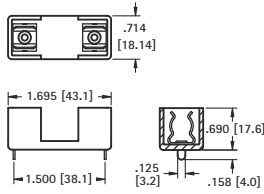

Optional Cover Cat. No. 3576C fits Cat. No. 3576 & 3574

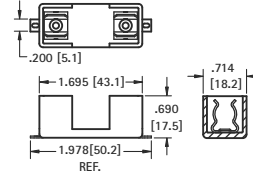

3574 (SMT)

Mounting Detail

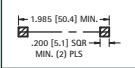

CAT. NO. 3576 - Holder

CAT. NO. 3576C - Cover only

CAT. NO. 3574 - Holder

CAT. NO. 3576C - Cover only

3AG FUSE BLOCKS

- Available with fiberglass or phenolic base
- Fuse clips riveted to base for rugged applications

SPECIFICATIONS

Phenolic Base: XP, Black UL Rated 94-HB

Fiberglass Base: GPO-3 UL Rated 94 V-0

Clips: .020 (.51) Brass - Nickel Plated

Rated: 15 Amps @ 500 VAC

Operating Temp. Range: -58°F to +292°F (-50°C to +145°C)

| BLACK PHENOLIC | FIBER-GLASS | HOLDS NO. OF FUSES | W |
|----------------|-------------|--------------------|--------------|
| 3536 | 3540 | 1 | .500 (12.7) |
| 3537 | 3541 | 2 | 1.125 (28.6) |
| 3538 | 3542 | 3 | 1.750 (44.5) |
| 3539 | 3543 | 4 | 2.375 (60.3) |

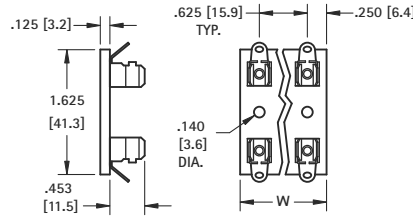

FUSE COVERS

- Made from flame retardant material
- Protects fuse from shorting and minor bumps



Can be used with clips 3512, 3512P, 3517 and 3518

MATERIAL: ABS, UL Rated 94V-0

| CAT. NO. | FUSE SIZE |
|--------------|------------|
| 3517C | 5mm x 20mm |

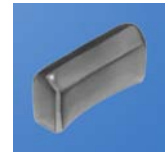
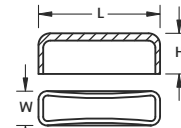
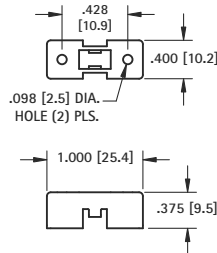

Can be used with clips or fuse holders

MATERIAL: PVC, UL Listed 94V-0

| CAT. NO. | FUSE SIZE | L | W | H |
|--------------|------------|--------------|-------------|-------------|
| 3527C | 5mm x 20mm | .945 (24.0) | .314 (8.0) | .512 (13.0) |
| 3521C | 2AG | .787 (20.0) | .295 (7.5) | .452 (11.5) |
| 4245C | 3AG | 1.319 (33.5) | .472 (12.0) | .591 (15.0) |

SUBMINIATURE FUSE HOLDERS

- Reliable spring tension assures low contact resistance
- Fuse holders allow for quick changing of subminiature fuses
- Ideal for high density circuit board applications

SPECIFICATIONS

Base: Thermoplastic, UL Rated 94V-0

Springs: Beryllium Copper, Gold Plate

Pins: Brass, Tin Plate

Current Rating: 5 Amps @ 250V AC



.335 (8.5) x .158 (4.0) FUSE

For Littelfuse 392/395 Type TE5®
Bussmann: PC Series
or equivalent



.335 (8.5) DIA. FUSE

For Littelfuse 370 Type TR5®
Bussmann: BK-EFF series
or equivalent



STURDI-MOUNT

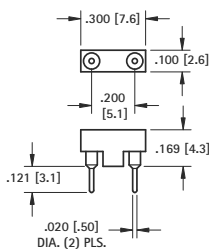

CAT. NO. 3552

LOW PROFILE

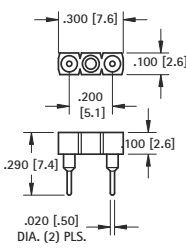

CAT. NO. 3553

STURDI-MOUNT

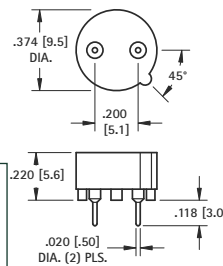

CAT. NO. 3556

LOW PROFILE

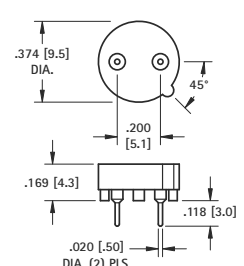

CAT. NO. 3554