

LARGE BANANA PLUGS - .300 (7.6)

Current Ratings: Large: (.300) 40 Amps

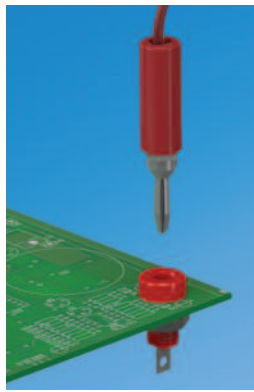

Supplied Unassembled

CAT. NO. 6073

INTERNAL THREAD

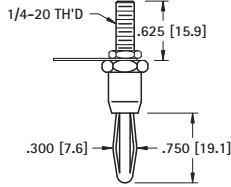

MATERIAL:
Spring: Phosphor Bronze,
Body: Brass, Nickel Plate



Supplied Unassembled

CAT. NO. 6075

EXTERNAL THREAD

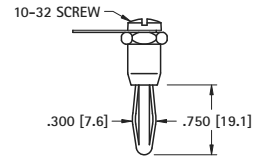

MATERIAL:
Spring: Phosphor Bronze
Body: Brass, Nickel Plate

STANDARD BANANA PLUGS - .175 (4.5)

Current Ratings: Standard: (.175) 15 Amps

SOLDERLESS CONNECTION

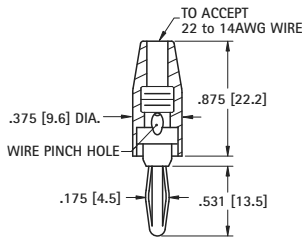

MATERIAL:
Spring: Nickel Silver
Body: Brass, Nickel Plate
Handle: Nylon

CAT. NO.	COLOR
6078	RED
6079	BLACK

SOLDERLESS WITH SET SCREW

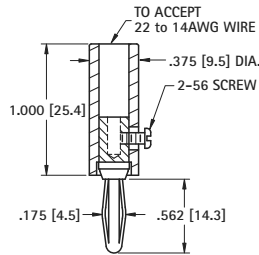

MATERIAL:
Spring: Nickel Silver
Body: Brass, Nickel Plate
Handle: Nylon

CAT. NO.	COLOR
6084	RED
6085	BLACK

INSULATED

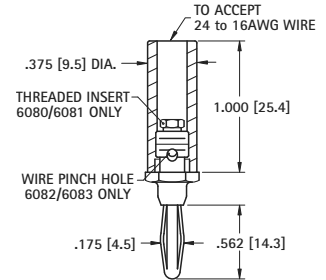

RED	BLACK	WIRE CONNECTION
CAT. NO.	CAT. NO.	
6080	6081	SOLDER
6082	6083	SOLDERLESS

MATERIAL:
Spring: Phosphor Bronze
Body: Brass, Nickel Plate
Handle: Nylon

SOLDER LUG

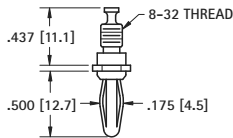

MATERIAL:
Spring: Beryllium Copper
Body: Brass, Nickel Plate

CAT. NO. 652

FOUR LEAF SPRING

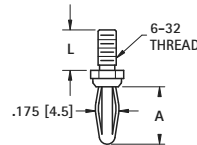

MATERIAL:
Spring: Beryllium Copper (Cat. No. 653)
Spring: Phosphor Bronze (Cat. No. 654, 655)
Body: Brass, Nickel Plate

CAT. NO.	L	A
653	.500 (12.7)	.437 (11.1)
654	.188 (4.8)	.550 (14.0)
655	.500 (12.7)	.550 (14.0)

BARREL SPRING

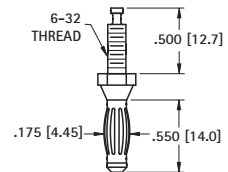

MATERIAL:
Spring: Beryllium Copper
Body: Brass, Nickel Plate

CAT. NO. 657

STANDARD RIVET

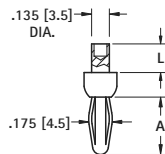

MATERIAL:
Four Leaf Spring: Phosphor Bronze
Barrel Spring: Beryllium Copper
Body: Brass, Nickel Plate

CAT. NO.	L	A	SPRING
552-3	.187 (4.7)	.437 (11.1)	4 leaf
658	.187 (4.7)	.550 (14.0)	barrel
552-4	.218 (5.5)	.437 (11.1)	4 leaf

INTERNAL THREAD

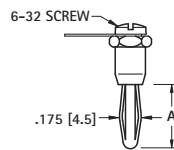

Supplied Unassembled

MATERIAL:
Four Leaf Spring: Phosphor Bronze
Barrel Spring: Beryllium Copper
Body: Brass, Nickel Plate

CAT. NO.	A	SPRING
6072	.531 (13.5)	4 leaf
659	.550 (14.0)	barrel

EXTERNAL THREAD

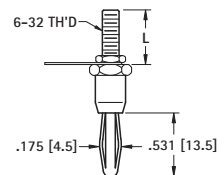

Supplied Unassembled

CAT. NO.	L
6074-1	.375 (9.5)
6074-2	.750 (19.1)

MATERIAL:
Spring: Phosphor Bronze
Body: Brass, Nickel Plate

BANANA PLUGS

MINI BANANA PLUGS - .120 (3.0)

Current Ratings: Miniature: (.120) 10 Amps

SWAGE MOUNT

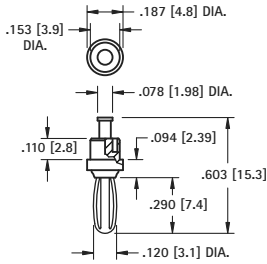

MATERIAL:
Spring: Beryllium Copper
Body: Brass, Silver Plate

CAT. NO. 452

THREADED

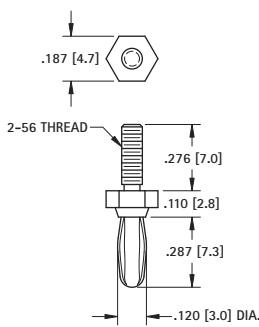

MATERIAL:
Spring: Beryllium Copper, Nickel Plate
Body: Brass, Silver Plate

CAT. NO. 450

SOLDER CONNECTION

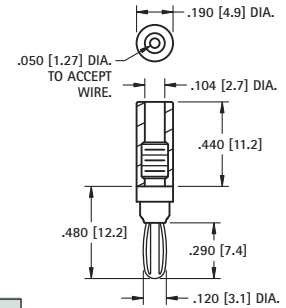

CAT. NO.	COLOR
6076	RED
6077	BLACK
451	NONE

MATERIAL:
Spring: Beryllium Copper, Nickel Plate
Body: Brass, Nickel Plate
Handle: Nylon

BANANA JACKS

LARGE BANANA JACK

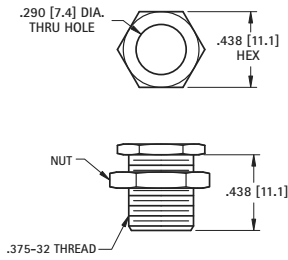

Accepts
 .300 (7.6)
 Plug

Supplied Unassembled

CAT. NO. 6098

MATERIAL:
Body: Brass, Nickel Plate
Terminal: Brass, Tin Plate

NON-INSULATED STANDARD JACKS

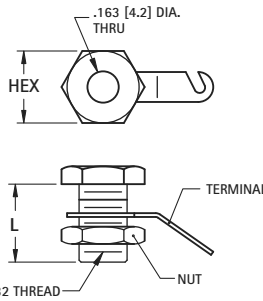

Accepts
 .175 (4.5)
 Plug

MATERIAL:
Body: Brass, Nickel Plate
Terminal: Brass, Tin Plate
 Supplied with nut and lug. Unassembled

CAT. NO.	HEX	L	DESCRIPTION
6095	.375 (9.5)	.406 (10.3)	Resessed head
6096	.312 (7.9)	.500 (12.7)	Narrow Head

INSULATED STANDARD JACKS

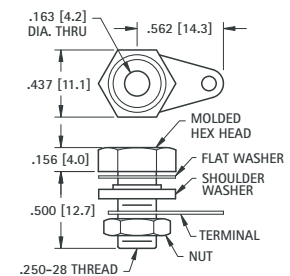

Accepts
 .175 (4.5)
 Plug

Supplied with hardware
 Unassembled

CAT. NO.	HEAD COLOR
6093	RED
6094	BLACK

MATERIAL:
Body: Brass, Nickel Plate
Terminal: Copper, Tinned
Hex Head: Phenolic

FULLY INSULATED STANDARD JACKS



Accepts
 .175 (4.5)
 Plug

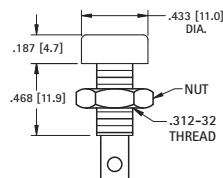

MATERIAL:
Body: Nylon
Contact: Brass, Tin Plate

CAT. NO.	COLOR
6091	RED
6092	BLACK

Mounting Detail

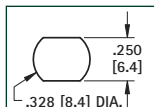

SWAGE MOUNT

STANDARD

Accepts
 .175 (4.5)
 Plug

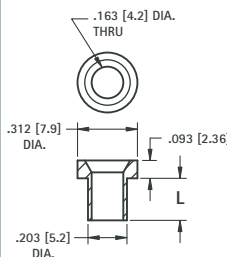

MATERIAL:
 Brass, Nickel Plate

CAT. NO.	L
575-4	.218 (5.5)
575-6	.265 (6.7)
575-8	.350 (8.9)

MINIATURE

Accepts
 .120 (3.0)
 Plug

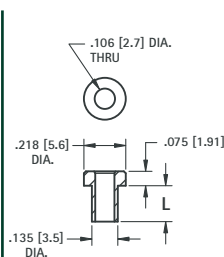

MATERIAL:
 Brass, Tin Plate

CAT. NO.	L
476-2	.125 (3.2)
476-3	.165 (4.2)
476-4	.187 (4.7)

MINIATURE BANANA JACK



Accepts
 .120 (3.0)
 Plug

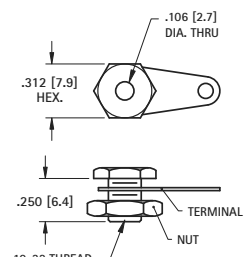

Supplied with lug and nut.
 Unassembled

CAT. NO. 6090

MATERIAL:
Body: Brass, Nickel Plate
Terminal: Copper, Tinned