

# THRU HOLE MOUNT (THM) BATTERY CLIPS

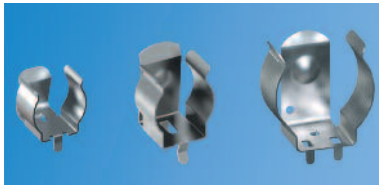

Refer to page 40 for Battery Contact Layout & Mounting Details

- Mounts securely to the PC board with advanced Snap-In design for thru hole mounting
- Reliable spring tension assures low contact resistance
- Low profile, economical design
- Retains battery securely to withstand shock and vibration

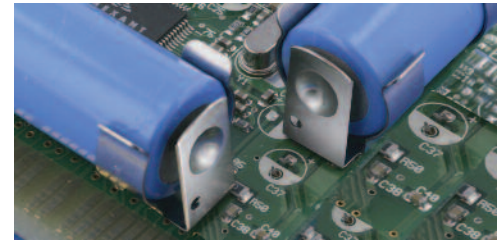

**MATERIAL:** Spring Steel, Tin-Nickel Plate

"AAAA" • "A27"

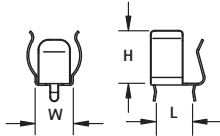

FIG. 1

"AAA" • "N" • "A23" • "AA" • "CR2"

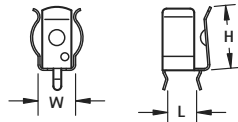

FIG. 2

"A" • "17500" • "18350"  
• "18650" • "20700" • "21700"

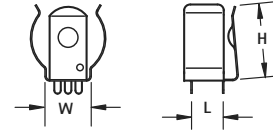

FIG. 3

CAT. NO.	FIG.	BATTERY SIZE	BATTERY DIAMETER	H	L	W
51	1	"AAAA" • "A27"	.300 - .350 (7.6 - 8.9)	.320 (8.1)	.194 (4.9)	.226 (5.7)
82	2	"AAA" • "N" • "A23"	.375 - .460 (9.5 - 11.7)	.525 (13.3)	.228 (5.8)	.296 (7.5)
52*	2	"AA" • "CR2"	No Ears	.525 (13.3)	.228 (5.8)	.250 (6.4)*
92	2	"AA" • "CR2"	.531 - .665 (13.5 - 16.9)	.593 (15.1)	.228 (5.8)	.369 (9.4)
2915**	2	"AA" • "CR2"	.531 - .665 (13.5 - 16.9)	.593 (15.1)	.228 (5.8)	.375 (9.5)
54	3	"A" • 17500 • 18350 • 18650	.630 - 748 (16.0 - 19.0)	.653 (16.6)	.300 (7.6)	.438 (11.1)
247	3	20700 • 21700	.787 - .827 (20.0 - 21.0)	.703 (17.9)	.378 (9.6)	.516 (13.1)

\* No Ears to hold battery

\*\* Heavy Duty Clip; .015 (.38) thick material

## SURFACE MOUNT (SMT) BATTERY CLIPS/CONTACTS



Refer to page 39 for Battery Contact Layout & Mounting Details

**AVAILABLE ON TAPE AND REEL**

- Flow-Hole SMT solder tail design for increased joint strength
- Tin-Nickel plating is ideal for lead free, high temperature soldering
- Matte Tin Plate for lower soldering temperatures ideal where other temperature sensitive components are being used

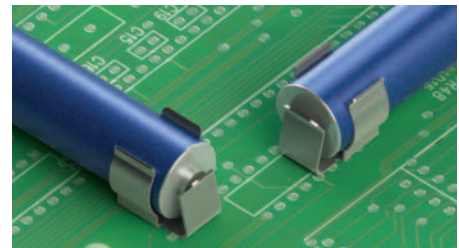

**MATERIAL:** Spring Steel, Tin-Nickel Plate

"AAAA" • "A27"

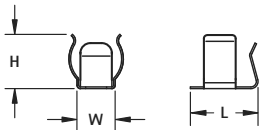

FIG. 4

"AAA" • "N" • "A23" • "AA" • "CR2"

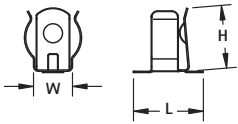

FIG. 5

"A" • "17500" • "18350"  
• "18650" • "20700" • "21700"

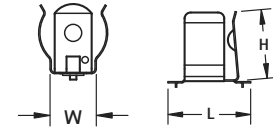

FIG. 6

TIN-NICKEL PLATE		MATTE TIN PLATE		FIG.	BATTERY SIZE	BATTERY DIAMETER	H	L	W
CAT. NO. BULK	ON TAPE & REEL	CAT. NO. BULK	ON TAPE & REEL						
50	50TR	550	550TR	4	"AAAA" • "A27"	.300 - .350 (7.6 - 8.9)	.320 (8.1)	.400 (10.2)	.226 (5.7)
55	55TR	555	555TR	5	"AAA" • "N" • "A23"	.375 - .460 (9.5 - 11.7)	.498 (12.7)	.671 (17.0)	.296 (7.5)
56*	56TR	556	556TR	5	"AA" • "CR2"	No Ears	.396 (10.1)	.613 (15.6)	.250 (6.4)*
53	53TR	553	553TR	5	"AA" • "CR2"	.531 - .665 (13.5 - 16.9)	.593 (15.1)	.662 (16.8)	.369 (9.4)
57*	57TR	557	557TR	5	"AA" • "CR2"	No Ears	.466 (11.87)	.613 (15.6)	.250 (6.4)*
254	254TR	—	—	6	"A" • 17500 • 18350 • 18650	.630 - 748 (16.0 - 19.0)	.653 (16.6)	.783 (19.9)	.438 (11.1)
246	246TR	—	—	6	20700 • 21700	.787 - .827 (20.0 - 21.0)	.703 (17.9)	.969 (24.6)	.516 (13.1)

\* No Ears to hold battery

# PC BUTTON & SPRING CONTACTS



- Space saving design installs directly onto the PC board
- Suitable for .062 (1.57) to .093 (2.36) PC boards
- Reliable spring tension assures low contact resistance
- Ideal for self-contained battery compartments

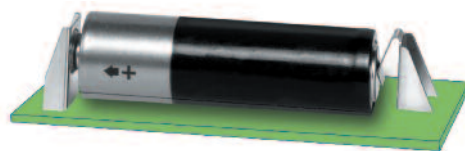

Refer to page 40 for Battery Contact Layout & Mounting Details

## COIL SPRING

"AA" - "CR2" - "A"

(+) POSITIVE BUTTON

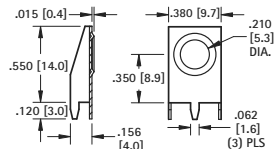

(-) NEGATIVE SPRING

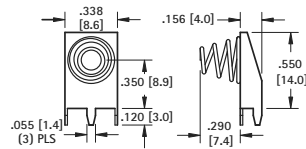

**MATERIAL:**  
Frame: .015 (.38)  
Steel, Tin-Nickel Plate

**CAT. NO. 595**

**MATERIAL:**  
Frame: .015 (.38) Steel,  
Matte Tin Plate

**CAT. NO. 628**

"AAA" - "N" - "A23"

(+) POSITIVE BUTTON

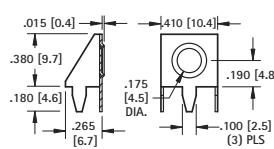

(-) NEGATIVE SPRING

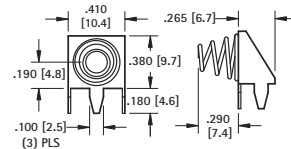

**MATERIAL:**  
Frame: .015 (.38) Steel,  
Tin-Nickel Plate

**CAT. NO. 637**

**MATERIAL:**  
Frame: .015 (.38)  
Steel, Matte Tin Plate

**CAT. NO. 629**

## LEAF SPRING

**MATERIAL:** .012 (.30) Spring Steel, Tin-Nickel Plate

"AA" - "CR2" - "A"

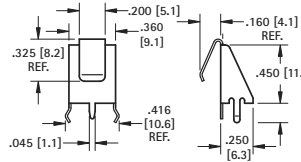
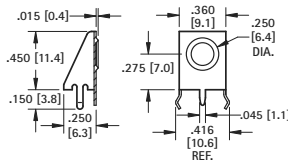

**CAT. NO. 596**

**CAT. NO. 590**

**MATERIAL:** .010 (.25) Spring Steel, Tin-Nickel Plate

"AAA" - "N" - "A23"

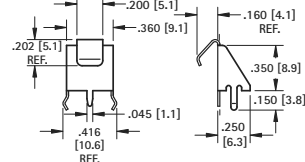
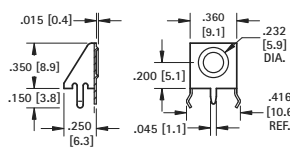

**CAT. NO. 597**

**CAT. NO. 591**

## SURFACE MOUNT LEAF-SPRING CONTACTS

AVAILABLE ON TAPE AND REEL

- Economical & reliable contacts are ideal for surface mount applications
- Unique spring tension contacts adjust to variations in battery length
- Reliable spring tension contacts assure low contact resistance
- SMT solder tail with "flow-hole" design for increased joint strength

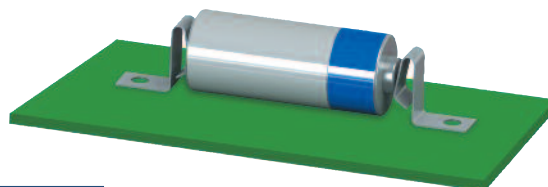

Refer to page 39 for Battery Contact Layout & Mounting Details

"AAA" - "AAAA" - "A23" - "N"

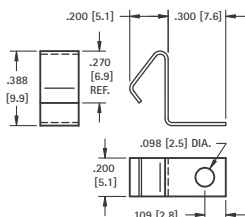

**MATERIAL:** .010 (.25) Spring Steel

TIN-NICKEL PLATE	MATTE TIN PLATE
CAT. NO. ON TAPE	CAT. NO. ON TAPE
BULK & REEL	BULK & REEL
5230 5230TR	5330 5330TR

Tape and Reel Spec's: 24mm wide; 12mm pitch; 13 inch reel (400 pieces per reel)

"AA" - "CR2" - "A" - "9V"

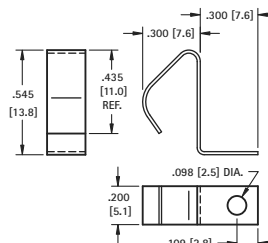

**MATERIAL:** .010 (.25) Spring Steel

TIN-NICKEL PLATE	MATTE TIN PLATE
CAT. NO. ON TAPE	CAT. NO. ON TAPE
BULK & REEL	BULK & REEL
5231 5231TR	5331 5331TR

Tape and Reel Spec's: 32mm wide; 16mm pitch; 13 inch reel (250 pieces per reel)

# SLIDE-IN PC MOUNT CONTACTS



- Reliable spring tension assure low contact resistance and dependable connection
- Symmetrical design allows these contacts to function both as a positive and negative contacts
- Economical and reliable contacts
- Designed for direct placement onto PCB, no wire leads required
- Unique spring tension adjusts to variations in battery length
- Stainless Steel contacts provide superior corrosion resistance

**MATERIAL:** .012 (.30) Stainless Steel

Refer to pages 39 & 41 for Battery Contact Layout & Mounting Details

## SURFACE MOUNT

### LEAF SPRING

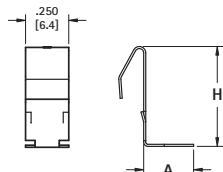

**Finish:** Gold Plate (Flash)

CAT. NO.	BATTERY SIZE	H	A
1020-1	"AAA"	.435 (11.1)	.250 (6.4)
1016-1	"AA"	.578 (14.9)	.289 (7.3)

### COIL SPRING

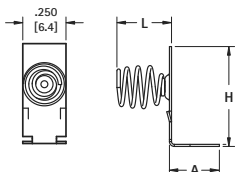
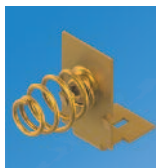

**Finish:** Gold Plate (Flash)

CAT. NO.	BATTERY SIZE	H	L	A
1076-2	"AAA"	.435 (11.1)	.325 (8.3)	.250 (6.4)
1088-2	"AA"	.578 (14.9)	.313 (8.0)	.289 (7.3)

### BUTTON CONTACT

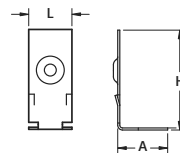

**Finish:** Gold Plate (Flash)

CAT. NO.	BATTERY SIZE	H
1076-1	"AAA"	.395 (10.0)
1088-1	"AA"	.545 (13.8)

## THRU HOLE MOUNT

### LEAF SPRING

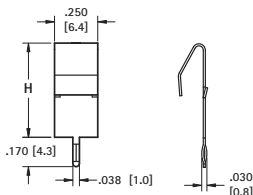

**Finish:** Tin-Nickel Plate

CAT. NO.	BATTERY SIZE	H
1021-1	"AAA"	.405 (10.3)
1017-1	"AA"	.545 (13.8)

### COIL SPRING

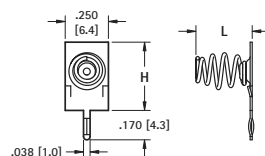

**Finish:** Tin-Nickel Plate

CAT. NO.	BATTERY SIZE	H	L
1075-2	"AAA"	.395 (10.0)	.326 (8.3)
1087-2	"AA"	.545 (13.8)	.313 (8.0)

### BUTTON CONTACT

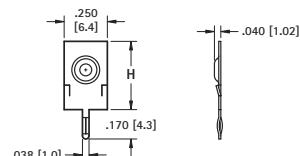

**Finish:** Tin-Nickel Plate

CAT. NO.	BATTERY SIZE	H	A
1075-1	"AAA"	.435 (11.1)	.250 (6.4)
1087-1	"AA"	.578 (14.9)	.289 (7.3)

### "AAA" · "N" · "AA" · "CR2" · "A"

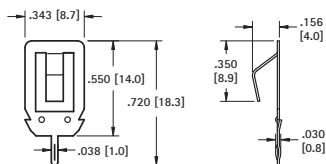

**Finish:** Tin-Nickel Plate

**CAT. NO. 108-2**

### "AA" · "A" · "17500" · "18350" · "18650" · "C" · "D"

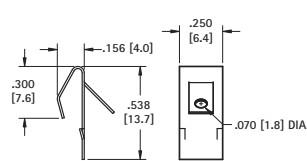

**Finish:** Tin-Nickel Plate

**CAT. NO. 1107-1**

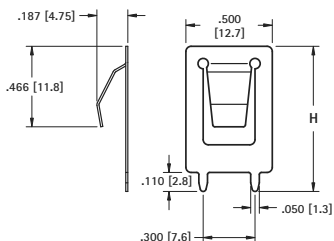

**MATERIAL:** .012 (.30) Spring Steel, Nickel Plate

CAT. NO.	(H) Height	BATTERY REFERENCE
109-2	.840 (21.3)	"AA" · "A" · "17500" · "18350" · "18650" · "C"
109-3	1.000 (25.4)	"20700" · "21700" · "D"

### "AAA" · "AAAA" · "N" · "12V"

"Off-Board" edge mounting design frees up valuable board space

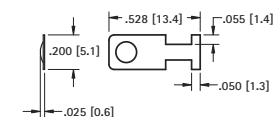

**CAT. NO. 230-1**

**MATERIAL:** .008 (.20) Spring Steel, Nickel Plate

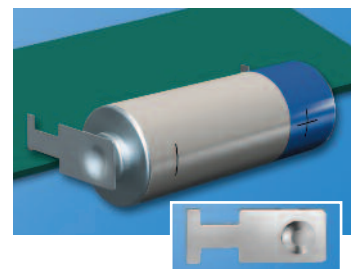

# SLIDE-IN PC MOUNT CONTACTS

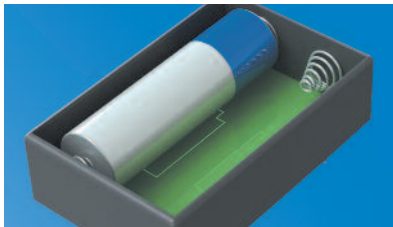

- Economical and reliable contacts
- Designed for direct placement onto PCB, no wire leads required
- Unique spring tension adjusts to variations in battery length
- Reliable spring tension assure low contact resistance and dependable connection

Refer to page 41 for Battery Contact Layout & Mounting Details

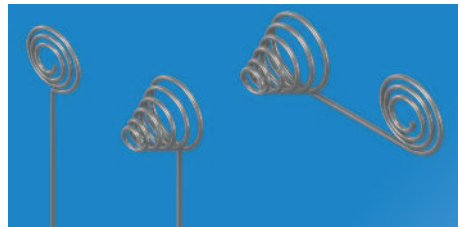

“AA” - “CR2” - “A” - “17500” - “18350” - “18650”

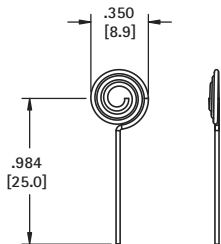

CAT. NO. 242

MATERIAL: .024 (.60) Music Wire, Nickel Plate

“AA” - “CR2” - “A” - “17500” - “18350” - “18650”

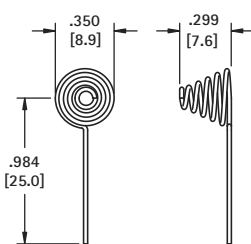

CAT. NO. 243

MATERIAL: .024 (.60) Music Wire, Nickel Plate

“AA”

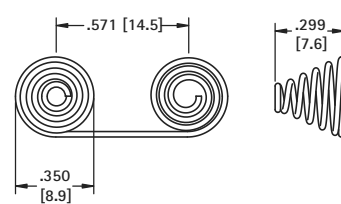

CAT. NO. 244

MATERIAL: .024 (.60) Music Wire, Nickel Plate

“AAAA” - “A23” - “A27” - “AAA” - “N”

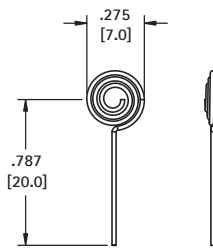

CAT. NO. 179

MATERIAL: .024 (.60) Music Wire, Nickel Plate

“AAAA” - “A23” - “A27” - “AAA” - “N”

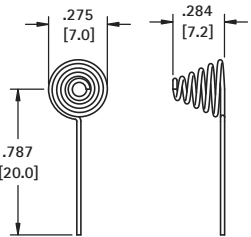

CAT. NO. 180

MATERIAL: .024 (.60) Music Wire, Nickel Plate

“AAA”

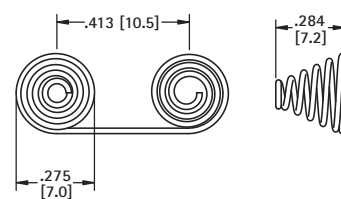

CAT. NO. 181

MATERIAL: .024 (.60) Music Wire, Nickel Plate

## BATTERY SPRING CONTACTS

THRU-HOLE MOUNT - “AA” - “CR2”

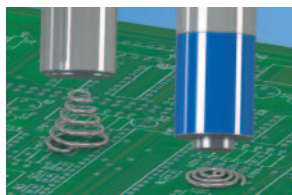

Solders directly to PCB, no wiring required

MATERIAL: .024 (.60) Dia Spring Steel, Nickel Plate

NEGATIVE

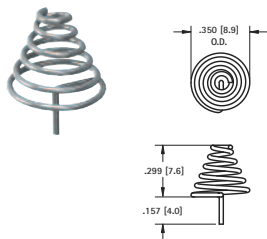

CAT. NO. 240

POSITIVE

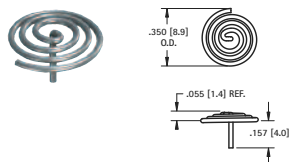

CAT. NO. 241

RIVET MOUNT

Easy to assemble with eyelets or rivets. Refer to page 146.

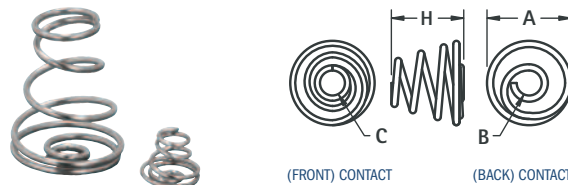

CAT. NO.	H	A	B	C	MATERIAL	CELL SIZE
211	.290 (7.4)	.335 (8.5)	.100 (2.5)	.140 (3.6)	.025 (.64) Dia. Spring Steel, Nickel Plate	“23 A” - “AA”
211-C	.550 (14.0)	.490 (12.4)	.118 (3.0)	.256 (6.5)	.040 (1.0) Dia. Spring Steel, Nickel Plate	“C”
211-D	.850 (21.6)	.650 (16.5)	.162 (4.1)	.300 (7.6)	.040 (1.0) Dia. Spring Steel, Nickel Plate	“D”



# SPRING & BUTTON CONTACTS

- Economical and reliable contacts are ideal for molded cases with self-contained battery compartments
- "Solder Tab" design for either wire lead or PC mounting
- Unique spring contacts adjust to variations in battery lengths
- Reliable spring contacts assure low contact resistance and a dependable connection
- Space saving, economical, excellent mechanical construction

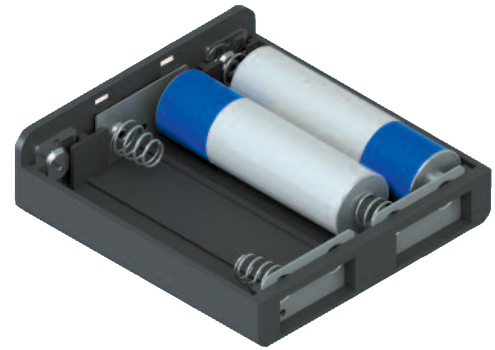

**MATERIAL:**

**Plate:** .020 (.51) Steel, Nickel Plate **Spring:** Spring Steel, Nickel Plate

Refer to page 42 for Battery Contact Layout & Mounting Details

**"AAA" • "AAAA" • "N" • "12V"**

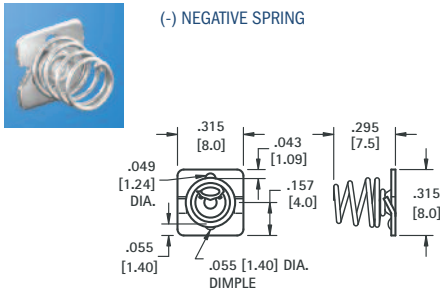

**CAT. NO. 5203**

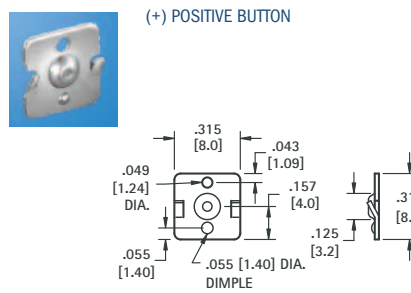

**CAT. NO. 5225**

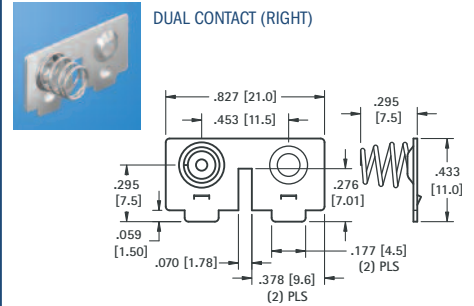

**CAT. NO. 5213**

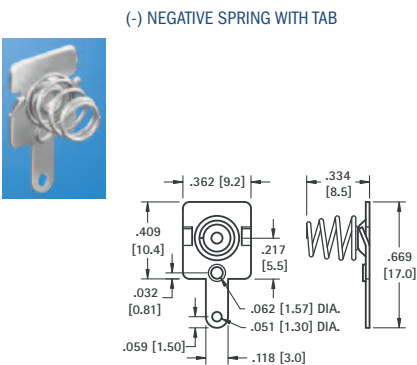

**CAT. NO. 5204**

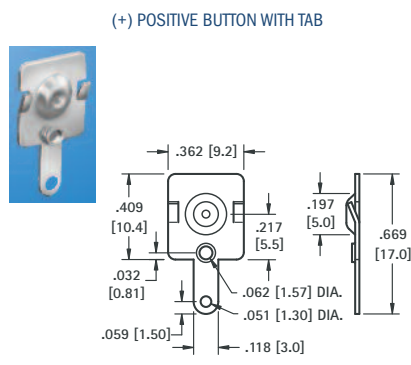

**CAT. NO. 5226**

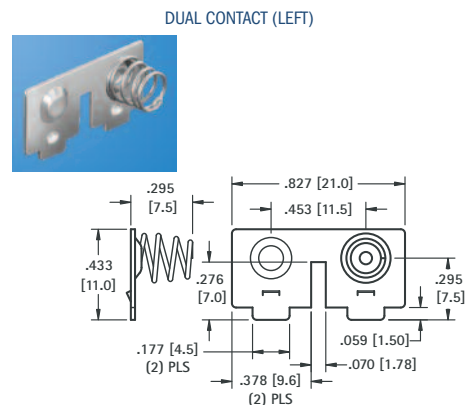

**CAT. NO. 5214**

**"AA" • "CR2" • "A" • "17500" • "18350" • "18650"**

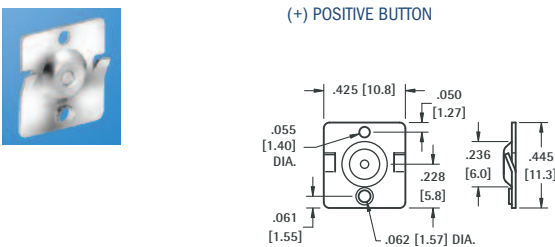

**CAT. NO. 5224**

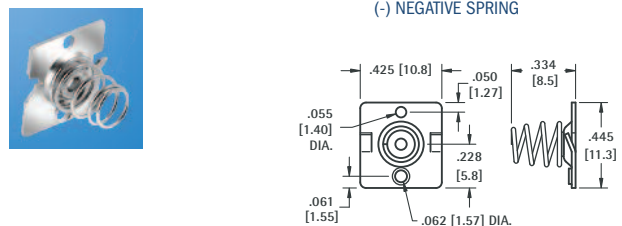

**CAT. NO. 5202**

**"AA"**

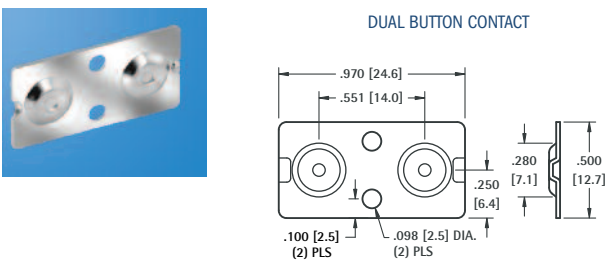

**CAT. NO. 5227**

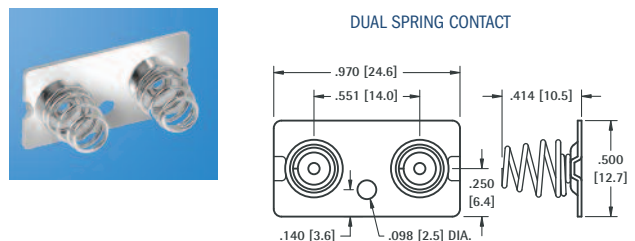

**CAT. NO. 5228**

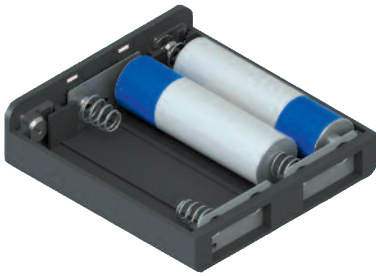

- Economical and reliable contacts are ideal for molded cases with self contained battery compartments
- "Solder Tab" design for either wire lead or PC mounting
- Unique spring contacts adjust to variations in battery lengths
- Reliable spring contacts assure low contact resistance and a dependable connection
- Space saving, economical, excellent mechanical construction

**MATERIAL:**

**Plate:** .020 (.51) Steel, Nickel Plate **Spring:** Spring Steel, Nickel Plate

Refer to page 42 for Battery Contact Layout & Mounting Details

"AA" - "CR2" - "A" - "17500" - "18350" - "18650"

(-) NEGATIVE SPRING

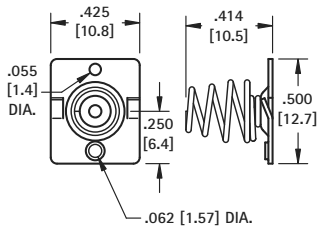

**CAT. NO. 5222**

(+) POSITIVE BUTTON

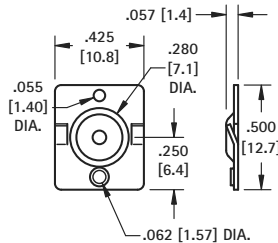

**CAT. NO. 5221**

DUAL CONTACT ("AA" ONLY)

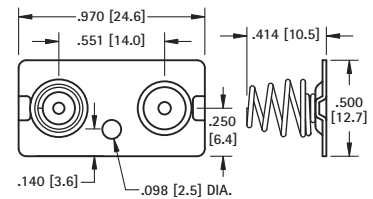

**CAT. NO. 5212** Left or Right

(-) NEGATIVE SPRING WITH TAB

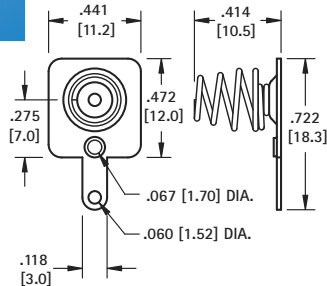

**CAT. NO. 5201**

(+) POSITIVE BUTTON WITH TAB

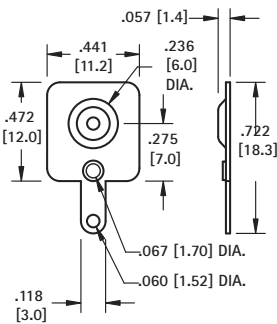

**CAT. NO. 5223**

DUAL CONTACT ("AA" ONLY)

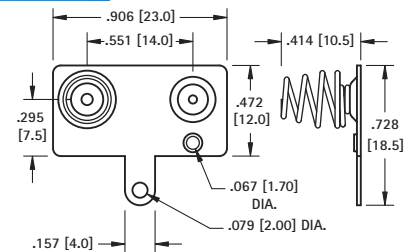

**CAT. NO. 5210** Left

**CAT. NO. 5211** Right (Shown)

(-) NEGATIVE SPRING WITH TAB/LANCE

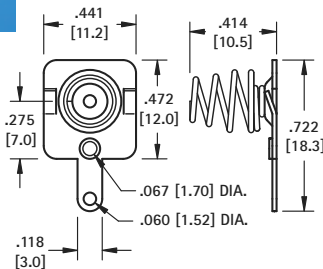

**CAT. NO. 5220**

(+) POSITIVE BUTTON WITH TAB/LANCE

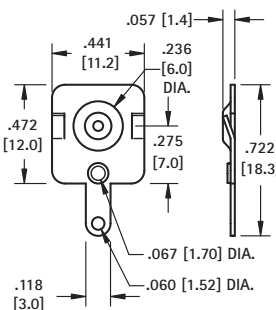

**CAT. NO. 5219**

DUAL CONTACT WITH TAB ("AA" ONLY)

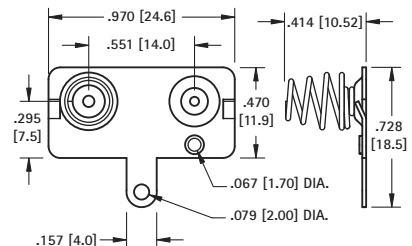

**CAT. NO. 5218** Left

**CAT. NO. 5217** Right (Shown)

# SPRING & BUTTON CONTACTS

- Economical and reliable contacts are ideal for molded cases with self contained battery compartments
- "Spring Tab" design for either wire lead or PC mounting
- Unique spring contacts adjust to variations in battery lengths
- Reliable spring contacts assure low contact resistance and a dependable connection
- Space saving, economical, excellent mechanical construction



**MATERIAL:**

**Plate:** .020 (.51) Steel, Nickel Plate **Spring:** Spring Steel, Nickel Plate

Refer to page 42 for Battery Contact Layout & Mounting Details

**"A" CELL**

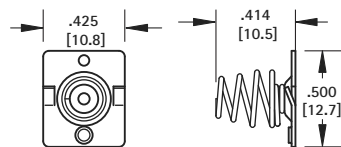

**CAT. NO. 5222**

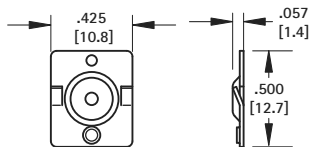

**CAT. NO. 5221**

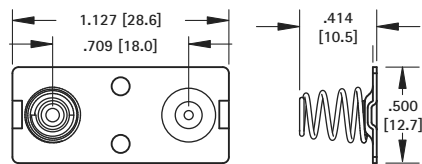

**CAT. NO. 5207**

**"C" CELL**



(+) POSITIVE BUTTON

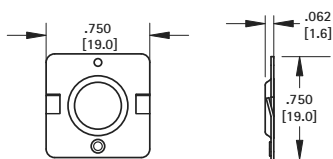

**CAT. NO. 5240**



(-) NEGATIVE SPRING

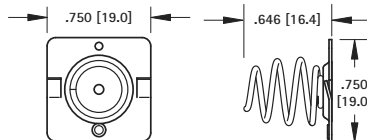

**CAT. NO. 5241**



DUAL CONTACT

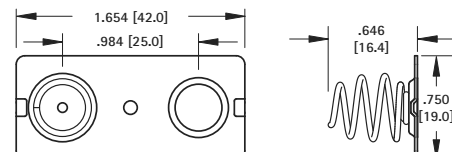

**CAT. NO. 5242**

**"D" CELL**



(+) POSITIVE BUTTON

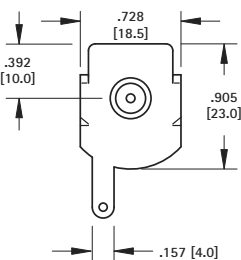

**CAT. NO. 5250**

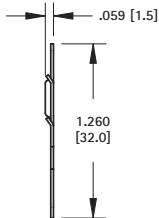

**CAT. NO. 5251**

(-) NEGATIVE SPRING

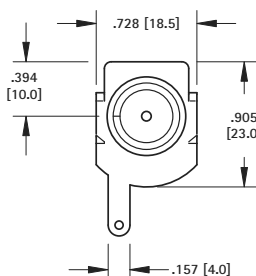

DUAL CONTACT

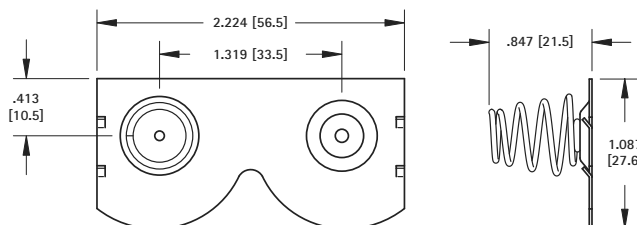

**CAT. NO. 5253** Left

**CAT. NO. 5252** Right (Shown)

BATTERY CONTACTS FOR MOLDED CASES

# SNAP-ON CONTACTS



- Economical and reliable contacts are ideal for molded cases with self contained battery compartments
- Solder "ear" to facilitate soldering of wire lead
- Unique spring tension contact adjusts to variations in battery length
- Reliable spring tension contacts assure low contact resistance
- Clips easily onto .060 (1.52) to .070 (1.78) wall
- Sharp barbs securely anchor contact in place

Refer to page 42 for Battery Contact Layout & Mounting Details

## "AAA" - "N" - "A23" - "A27"



**CAT. NO. 204**

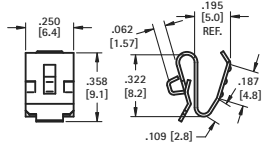

**MATERIAL:** .010 (.25) Spring Steel, Nickel Plate



**CAT. NO. 238**

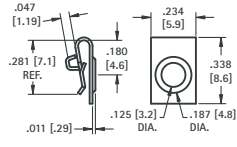

**MATERIAL:** .010 (.25) Stainless Steel, Nickel Plate

## "AAA"



**CAT. NO. 202**

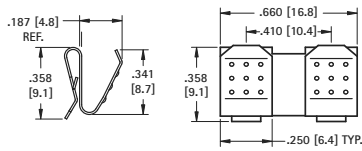

**MATERIAL:** .010 (.25) Spring Steel, Nickel Plate



**CAT. NO. 294**

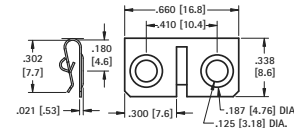

**MATERIAL:** .010 (.25) Stainless Steel, Nickel Plate



**CAT. NO. 295**

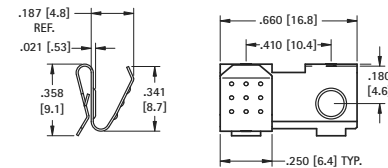

**MATERIAL:** .010 (.25) Spring Steel, Nickel Plate

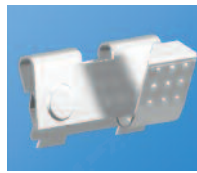

**CAT. NO. 296**

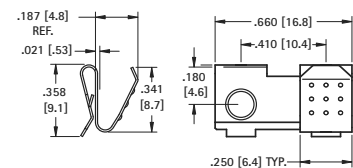

**MATERIAL:** .010 (.25) Spring Steel, Nickel Plate

## "AA" - "CR2" - "A" - "17500" - "18350" - "18650"



**CAT. NO. 209**

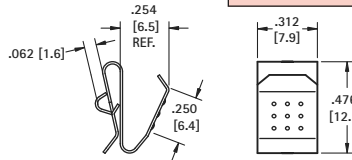

**MATERIAL:** .012 (.30) Spring Steel, Nickel Plate



**CAT. NO. 228**

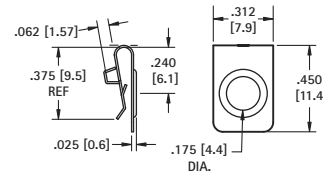

**MATERIAL:** .010 (.25) Stainless Steel, Nickel Plate

## "AA"



**CAT. NO. 288**

The (2) two leaf contacts are separate, allowing a divider between the batteries.

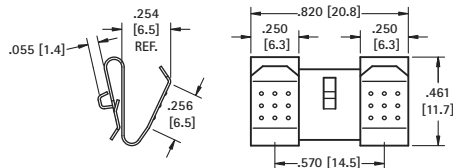

**MATERIAL:** .012 (.30) Spring Steel, Nickel Plate



**CAT. NO. 292**

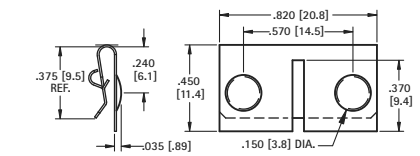

**MATERIAL:** .010 (.25) Stainless Steel, Nickel Plate



**CAT. NO. 210**

The (2) two leaf contacts are held together by a web. This design offers greater stability.

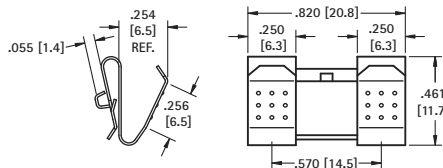

**MATERIAL:** .012 (.30) Spring Steel, Nickel Plate



**CAT. NO. 291** Right

**CAT. NO. 290** Left (shown)

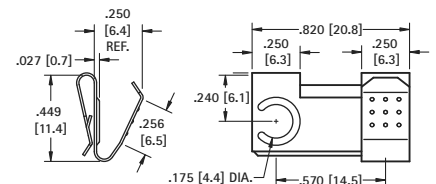

**MATERIAL:** .012 (.30) Spring Steel, Nickel Plate



# SNAP-ON COIL SPRING CONTACTS

- Ideal for applications that have a self contained battery compartment
- Coil Springs will rebound after drop
- Reliable tension against battery help to assure low contact assistance

- Sharp barbs securely anchor contact in place
- Clips easily over .060 (1.5) to 0.70 (1.8) wall
- Long spring will accommodate variations in battery lengths



MATERIAL: Steel, Nickel Plate

Refer to page 42 for Battery Contact Layout & Mounting Details

“AAA”

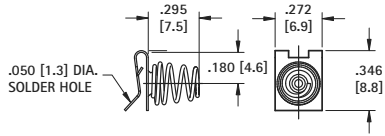

CAT. NO. 267

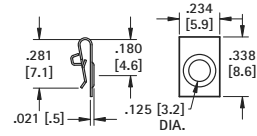

CAT. NO. 238

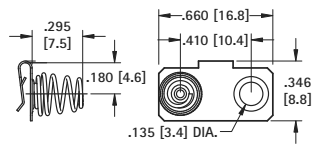

CAT. NO. 299

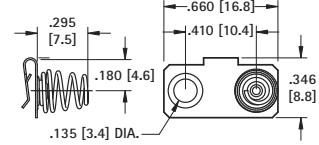

CAT. NO. 287

“AA”

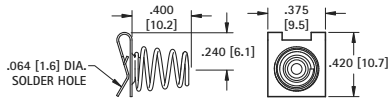

CAT. NO. 289

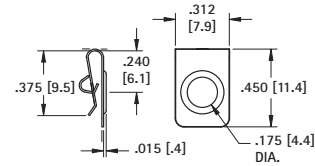

CAT. NO. 228

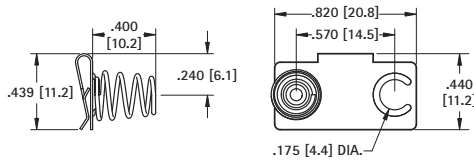

CAT. NO. 297

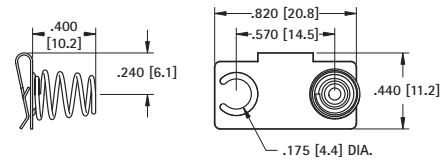

CAT. NO. 293

## SLIDE-IN MOUNT CONTACTS

“AA” - “CR2” - “A” - “9V” - “17500” - “18350” - “18650”

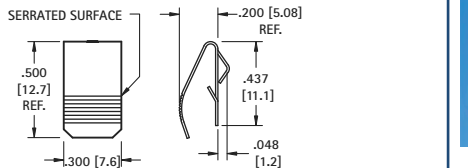

CAT. NO. 5205

MATERIAL: .012 (.30) Spring Steel, Nickel Plate

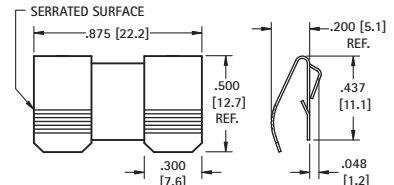
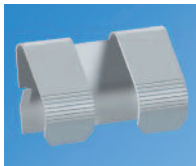

CAT. NO. 5208

MATERIAL: .012 (.30) Spring Steel, Nickel Plate

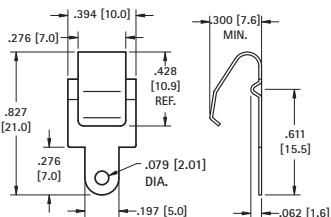

CAT. NO. 5209

MATERIAL: .012 (.30) Phosphor Bronze, Nickel Plate

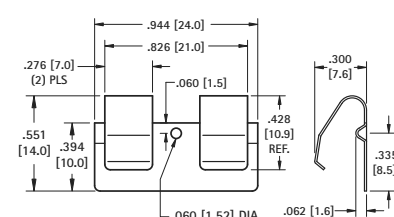

CAT. NO. 5208

MATERIAL: .012 (.30) Phosphor Bronze, Nickel Plate

## RUGGED STEEL BATTERY CLIPS

"AA" - "C" - "D"

Refer to page 41 for Battery Contact Layout & Mounting Details

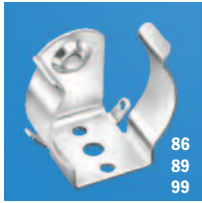

Non-Insulated

**Base:** Steel, Nickel Plate  
**Contacts:** Brass, Nickel Plate

- Available with and without insulated contact
- Non-Insulated contact will ground battery connection
- Insulated Contacts supplied with brass solder lug
- Ideal for creating custom battery holders



Insulated

CAT. NO.	FIGURE	L	W	H	CELL SIZE
99	Non-Insulated	.703 (17.9)	.359 (9.1)	.609 (15.5)	"AA"
100	Insulated				
86	Non-Insulated	.703 (17.9)	.606 (15.4)	.953 (24.2)	"C"
87	Insulated				
89	Non-Insulated	.780 (19.8)	.606 (15.4)	1.160 (29.5)	"D"
88	Insulated				

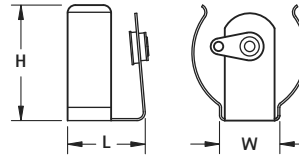

## ECONOMY CONTACTS

"AA" - "C" - "D"

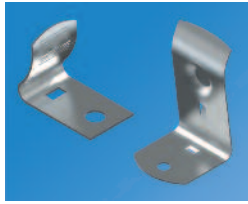

Refer to page 41 for Battery Contact Layout & Mounting Details

- Designed for mounting in self-contained, non-metallic battery compartments
- Reliable spring tension assures low contact resistance
- Recessed contact holds battery in place
- All clips have anti-rotation tab

CAT. NO.	L	W	H	CELL SIZE
206	.625 (15.9)	.375 (9.5)	.500 (12.7)	"AA"
207	.687 (17.4)	.375 (9.5)	.875 (22.2)	"C"
208	.750 (18.1)	.687 (17.5)	1.260 (32.0)	"D"

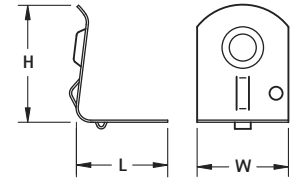

**MATERIAL:** .016 (.41) Spring Steel, Nickel Plate

## ALUMINUM & STEEL CLIPS

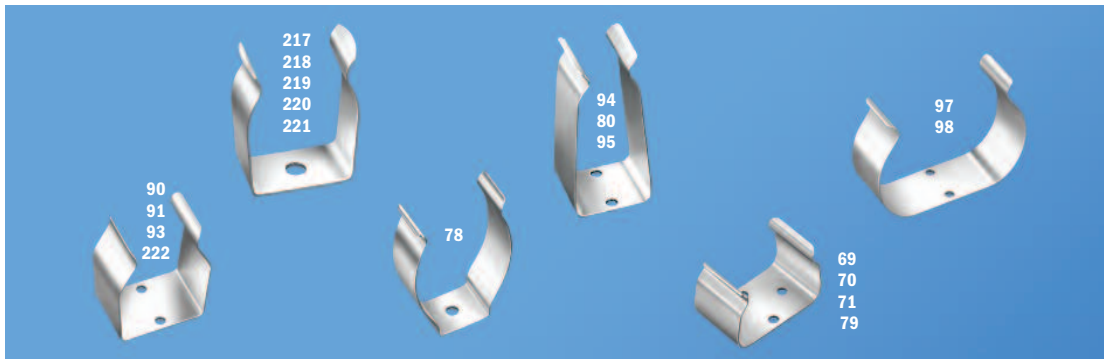

**MATERIAL:** Steel Clips: Spring Steel, Nickel Plate Aluminum Clips: 2024-T3

CAT. NO.	DESCRIPTION	MATERIAL
<b>"AAAA" Cell (7.5 - 8.5mm Dia)</b>		
251	One cell	Steel
<b>"AAA" Cell (9.5 - 12mm Dia)</b>		
90	One cell	Aluminum
<b>"AA", "CR2" Cell (13.5 - 17.0mm Dia)</b>		
91	One cell	Aluminum
69	Two Cell	Steel
<b>"A" Cell (16.0 - 18.0mm Dia)</b>		
70	Two Cell	Aluminum

CAT. NO.	DESCRIPTION	MATERIAL
<b>Sub C Cell (22.0 - 23.0mm Dia)</b>		
221	One cell	Steel
<b>C Cell (22.0 - 29.0mm Dia)</b>		
222	One cell	Steel
93	One cell	Aluminum
97	Two Cell	Aluminum
<b>D Cell (30.0 - 35.0mm Dia)</b>		
94	One cell	Aluminum
78	One cell	Steel
98	Two Cell	Aluminum

CAT. NO.	DESCRIPTION	MATERIAL
<b>NiCd Cell</b>		
217	One cell, 35-38mm Dia.	Steel
218	One cell, 36-43mm Dia.	Steel
219	One cell, 51-64mm Dia.	Steel
<b>9V Cell</b>		
71	Horizontal, Low Profile	Steel
79	Horizontal	Steel
80	Vertical	Steel
95	Vertical	Aluminum
66	Horizontal, Lithium-Ion	Steel

## BATTERY RETAINER CLIPS



- Prevents battery from loosening in battery holder
- Retainer clip slips on the ears of the battery holder clip

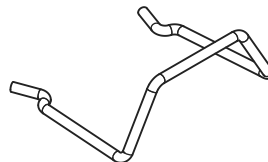

CAT. NO.	CELL	CAN BE USED WITH CAT. NO.s
61	"AA", "CR2"	91, 92, 95, 99, 100, 2915
62	"C"	86, 87, 93, 222
63	"D"	78, 88, 89, 94