

SMT BATTERY CONTACT & PAD LAYOUTS

NOTE: ALL MOUNTING DIMENSIONS ARE FOR REFERENCE ONLY. PLEASE VERIFY YOUR BATTERY LAYOUT PRIOR TO FABRICATION.



50
550

CAT. NO.	"L" DIMENSION	
	For "AAAA"	For "A27"
50	0.33 (8.4) × 1.67 (42.4)	0.30 (7.6) × 1.10 (28.0)
550	0.89 (22.6)	0.32 (8.1)

Refer to page 13 for Part Details

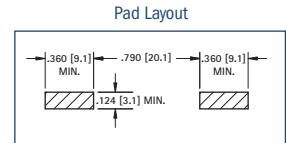

Pad Layout



55
555

CAT. NO.	"L" DIMENSION		
	For "AAA"	For "N"	For "A23"
55	0.41 (10.4) × 1.75 (44.5)	0.45 (11.4) × 1.14 (29.0)	0.40 (10.2) × 1.10 (27.9)
555	1.76 (44.7)	1.15 (29.2)	1.11 (28.2)

Refer to page 13 for Part Details

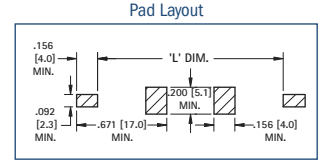

Pad Layout



53
553

CAT. NO.	"L" DIMENSION		
	For "AA"	For "2/3 A"	For "CR2"
53	0.56 (14.2) × 1.98 (50.3)	0.67 (17.0) × 1.36 (34.5)	0.60 (15.2) × 1.05 (26.7)
553	2.05 (52.1)	1.38 (35.1)	1.04 (26.4)

Refer to page 13 for Part Details

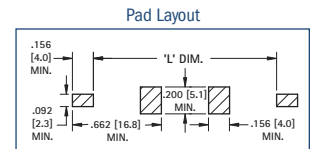

Pad Layout



254
246

CAT. NO.	"L" DIMENSION		
	For "2/3 A"	For "18350"	For "18650"
254	0.67 (17.0) × 1.36 (34.5)	0.71 (18.0) × 1.38 (35.0)	0.71 (18.0) × 2.56 (65.0)
246	.270 (6.9)	.324 (8.2)	1.58 (40.2)

CAT. NO.	"L" DIMENSION		
	For "20600"	For "20700"	For "21700"
246	0.79 (20.0) × 2.36 (60.0)	0.79 (20.0) × 2.76 (70.0)	0.83 (21.0) × 2.76 (70.0)
246	1.10 (28.0)	1.50 (38.0)	1.49 (38.0)

Refer to page 13 for Part Details

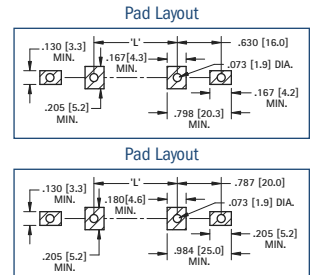

Pad Layout

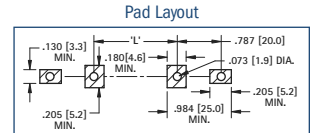

Pad Layout



56
556
57
557

CAT. NO.	"L" DIMENSION		
	For "AAA"	For "N"	For "A23"
56	0.41 (10.4) × 1.75 (44.5)	0.45 (11.4) × 1.14 (29.0)	0.4 (10.2) × 1.10 (27.9)
556	1.67 (42.4)	1.07 (27.2)	1.02 (25.9)

CAT. NO.	"L" DIMENSION		
	For "AA"	For "2/3 A"	For "CR2"
57	0.56 (14.2) × 1.98 (50.3)	0.67 (17.0) × 1.36 (34.5)	0.60 (15.2) × 1.05 (26.7)
557	1.90 (48.3)	1.23 (31.2)	0.97 (24.6)

Refer to page 13 for Part Details

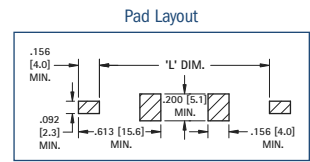

Pad Layout



5231
5331
5230
5330

CAT. NO.	"L" DIMENSION		
	For "AA"	For "2/3 A"	For "CR2"
5231	0.56 (14.2) × 1.98 (50.3)	0.67 (17.0) × 1.36 (34.5)	0.60 (15.2) × 1.05 (26.7)
5331	2.38 (60.5)	1.71 (43.4)	1.53 (24.6)

CAT. NO.	"L" DIMENSION				
	For "AAA"	For "N"	For "A23"	For "A27"	For "AAAA"
5230	0.41 (10.4) × 1.75 (44.5)	0.45 (11.4) × 1.14 (29.0)	0.40 (10.2) × 1.10 (27.9)	0.30 (7.6) × 1.10 (27.9)	0.33 (8.4) × 1.67 (42.4)
5330	1.96 (49.8)	1.35 (34.3)	1.31 (33.3)	1.31 (33.3)	1.86 (47.2)

Refer to page 14 for Part Details

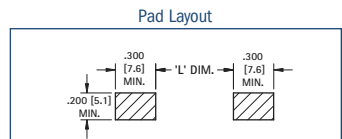

Pad Layout

"L" dimensions reflect initial insertion deflection.



1016-1
1020-1

CAT. NO.	"L" DIMENSION				
	For "AAA"	For "N"	For "A27"	For "A23"	For "AAAA"
1020-1	0.41 (10.4) × 1.75 (44.5)	0.45 (11.4) × 1.14 (29.0)	0.30 (7.6) × 1.10 (27.9)	0.33 (8.4) × 1.67 (42.4)	0.33 (8.4) × 1.67 (42.4)
1076-1	2.42 (61.5)	1.81 (46.0)	1.77 (44.9)	2.34 (59.4)	2.34 (59.4)
1076-2					

Refer to page 15 for Part Details

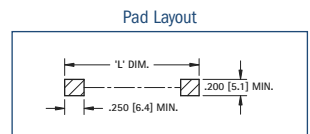

Pad Layout



1076-2
1088-2

CAT. NO.	"L" DIMENSION		
	For "AA"	For "2/3 A"	For "CR2"
1016-1	0.56 (14.2) × 1.98 (50.3)	0.67 (17.0) × 1.36 (34.5)	0.60 (14.2) × 1.05 (26.7)
1088-1	2.72 (69.1)	2.10 (53.3)	1.79 (45.5)
1088-2			

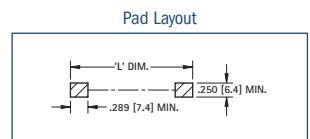

Pad Layout

THM BATTERY CLIP & CONTACT LAYOUTS AND MOUNTING DETAILS

NOTE: ALL MOUNTING DIMENSIONS ARE FOR REFERENCE ONLY. VERIFY YOUR BATTERY LAYOUT PRIOR TO FABRICATION.

BATTERY CONTACT LAYOUTS & MOUNTING DETAILS

Refer to page 13 for Part Details

Mounting Detail

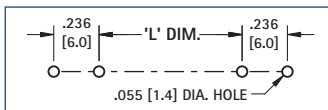

CAT. NO.	"L" DIMENSION	
	For "AAA"	For "A27"
51	0.33 (8.4) × 1.67 (42.4)	0.300 (7.6) × 1.10 (27.9)



51

Refer to page 13 for Part Details

Mounting Detail

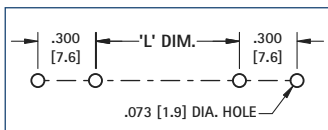

CAT. NO.	"L" DIMENSION		
	For "AAA"	For "N"	For "A23"
82	0.41 (10.4) × 1.75 (44.5)	0.45 (11.4) × 1.14 (29.0)	0.40 (10.2) × 1.10 (27.9)



82
92
2915



52

CAT. NO.	"L" DIMENSION		
	For "AA"	For "2/3 A"	For "CR2"
52	0.56 (14.2) × 1.98 (50.3)	0.67 (17.0) × 1.36 (34.5)	0.60 (15.2) × 1.05 (26.7)
92	1.32 (33.5)	-	0.39 (9.9)
2915	1.32 (33.5)	-	0.39 (9.9)

Refer to page 13 for Part Details

Mounting Detail

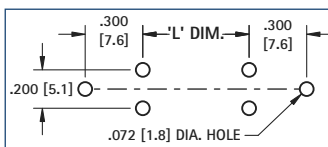

CAT. NO.	"L" DIMENSION			
	For "18650"	For "18350"	For "2/3 A"	For "17500"
54	0.71 (18.4) × 2.56 (65.0)	0.73 (18.5) × 1.38 (35.0)	0.67 (17.0) × 1.36 (34.5)	0.67 (17.0) × 1.97 (50.0)



54

Refer to page 13 for Part Details

Mounting Detail

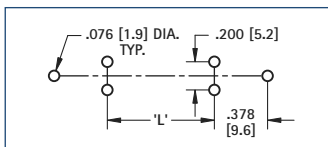

CAT. NO.	"L" DIMENSION		
	For "20600 A"	For "20700"	For "21700"
247	0.79 (20.0) × 2.36 (60.0)	0.79 (20.0) × 2.76 (70.0)	0.83 (21.0) × 2.76 (70.0)



247

Refer to page 14 for Part Details

Mounting Detail

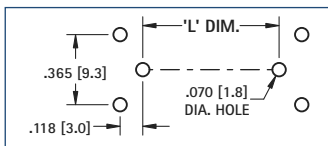

CAT. NO.	"L" DIMENSION		
	For "2/3 A"	For "CR2"	For "AA"
595 with 628	0.67 (17.0) × 1.36 (34.5)	0.60 (15.2) × 1.05 (26.7)	0.56 (14.2) × 1.98 (50.3)



595



628

Refer to page 14 for Part Details

Mounting Detail

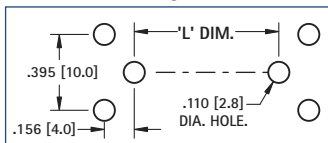

CAT. NO.	"L" DIMENSION		
	For "AAA"	For "N"	For "A23"
637 with 629	0.41 (10.4) × 1.75 (44.5)	0.45 (11.4) × 1.14 (29.0)	0.40 (10.2) × 1.10 (27.9)



637



629

Refer to page 14 for Part Details

Mounting Detail

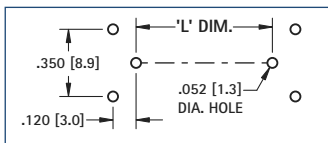

CAT. NO.	"L" DIMENSION		
	For "AA"	For "2/3 A"	For "CR2"
596 with 590	0.56 (14.2) × 1.98 (50.3)	0.67 (17.0) × 1.36 (34.5)	0.60 (15.2) × 1.05 (26.7)
590 with 590	2.07 (52.6)	N/A	1.14 (29.0)



596
597



590
591

CAT. NO.	"L" DIMENSION		
	For "AAA"	For "N"	For "A23"
597 with 591	0.41 (10.4) × 1.75 (44.5)	0.45 (11.4) × 1.14 (29.0)	0.40 (10.2) × 1.10 (27.9)
591 with 591	1.83 (46.5)	1.30 (33.0)	1.26 (32.0)

"L" dimensions reflect initial insertion deflection.

BATTERY CONTACT LAYOUTS AND MOUNTING DETAILS

NOTE: ALL MOUNTING DIMENSIONS ARE FOR REFERENCE ONLY. PLEASE VERIFY YOUR BATTERY LAYOUT PRIOR TO FABRICATION.

Refer to page 15 & 21 for Part Details

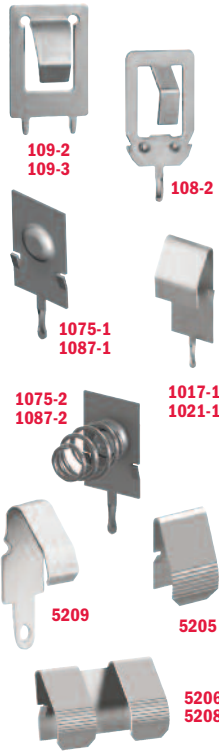

CAT. NO.	FIG. NO.	L DIMENSION					
		For "AA" 0.56 (14.2) × 1.98 (50.3)	For "CR2" 0.60 (15.2) × 1.05 (26.7)	For "2/3 A" 0.67 (17.0) × 1.36 (34.5)	For "17500"* 0.67 (17.0) × 1.97 (50.0)	For "18350"* 0.71 (18.0) × 1.38 (35.0)	For "18650"* 0.71 (18.0) × 2.56 (65.0)
5205	3	2.28 (57.9)	1.35 (34.3)	1.66 (42.1)	2.27 (57.7)	1.68 (42.7)	2.86 (72.6)
5205 with 5206	3	2.28 (57.9)	N/A	N/A	N/A	N/A	N/A
5209	3	2.34 (59.4)	1.41 (35.8)	1.72 (43.6)	2.33 (59.2)	1.74 (44.2)	2.92 (74.2)
5209 with 5208	3	2.34 (59.4)	N/A	N/A	N/A	N/A	N/A
1017-1 1087-1 1087-2	3	2.19 (55.6)	1.26 (32.0)	1.57 (39.8)	2.18 (55.4)	1.59 (40.4)	2.77 (70.4)

*Built in circuit protection may increase length of battery, check battery specifications for exact battery length

CAT. NO.	FIG. NO.	L DIMENSION				
		For "AAAA" 0.33 (8.4) × 1.67 (42.4)	For "A27" 0.30 (7.6) × 1.10 (27.9)	For "A23" 0.40 (10.2) × 1.10 (27.9)	For "AAA" 0.41 (10.4) × 1.75 (44.5)	For "N" 0.45 (11.4) × 1.14 (29.0)
1021-1 1075-1 1075-2	3	1.88 (47.8)	1.31 (33.3)	1.31 (33.3)	1.96 (49.8)	1.35 (34.3)

CAT. NO.	FIG. NO.	L DIMENSION				
		For "AAA" 0.41 (10.4) × 1.75 (44.5)	For "N" 0.45 (11.4) × 1.14 (29.0)	For "AA" 0.56 (14.2) × 1.98 (50.3)	For "CR2" 0.60 (15.2) × 1.05 (26.7)	For "2/3A" 0.67 (17.0) × 1.24 (31.5)
108-2	3	1.99 (50.5)	1.38 (35.0)	2.22 (56.4)	1.29 (32.8)	1.55 (39.4)

CAT. NO.	FIG. NO.	L DIMENSION									
		For "AA" 0.56 (14.2) × 1.98 (50.3)	For "CR2" 0.60 (15.2) × 1.05 (26.7)	For "2/3 A" 0.67 (17.0) × 1.24 (31.5)	For "17500"* 0.67 (17.0) × 1.97 (50.0)	For "18350"* 0.71 (18.0) × 1.38 (35.0)	For "18650"* 0.71 (18.0) × 2.56 (65.0)	For "C" 0.99 (25.0) × 1.97 (50.0)	For "26650" 1.02 (26.0) × 2.56 (65.0)	For "D" 1.30 (33.0) × 2.24 (56.9)	
1107-1	3	2.19 (55.6)	1.26 (32.0)	1.52 (38.6)	2.18 (55.4)	1.59 (40.4)	2.77 (70.4)	2.18 (55.4)	2.77 (70.4)	2.45 (62.2)	
109-2	3	2.22 (56.4)	1.29 (32.8)	1.55 (39.4)	2.21 (56.1)	1.62 (41.1)	2.80 (71.1)	N/A	N/A	N/A	
109-3	3	N/A	N/A	N/A	N/A	N/A	N/A	2.21 (56.1)	1.62 (41.1)	2.48 (63.0)	

*Built in circuit protection may increase length of battery, check battery specifications for exact battery length

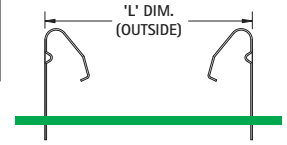

Fig. 3 PC Mount
L dimensions reflect initial insertion deflection.

Refer to page 15 for Part Details



CAT. NO.	FIG. NO.	L DIMENSION				
		For "AAAA" 0.33 (8.4) × 1.67 (42.4)	For "A27" 0.30 (7.6) × 1.10 (27.9)	For "A23" 0.40 (10.2) × 1.10 (27.9)	For "AAA" 0.41 (10.4) × 1.75 (44.5)	For "N" 0.45 (11.4) × 1.14 (29.0)
230-1	5	1.67 (42.4)	1.10 (27.9)	1.10 (27.9)	1.73 (43.9)	1.14 (29.0)

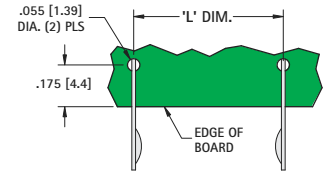
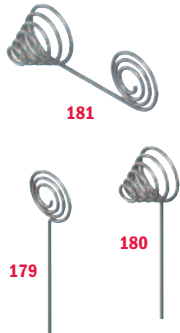

Fig. 5 Off-Board Mount

Refer to page 16 for Part Details



CAT. NO.	L DIMENSION				
	For "AAAA" 0.33 (8.4) × 1.67 (42.4)	For "A27" 0.30 (7.6) × 1.10 (27.9)	For "A23" 0.40 (10.2) × 1.10 (27.9)	For "AAA" 0.41 (10.4) × 1.75 (44.5)	For "N" 0.45 (11.4) × 1.14 (29.0)
179 180 181	1.88 (47.8)	1.27 (32.3)	1.23 (31.2)	1.23 (31.2)	1.80 (45.7)

CAT. NO.	L DIMENSION					
	For "AA" 0.56 (14.2) × 1.98 (50.3)	For 2/3 "A" 0.67 (17.0) × 1.36 (34.5)	For "CR2" 0.60 (14.2) × 1.05 (26.7)	For "17500" 0.67 (17.0) × 1.97 (50.0)	For "18350" 0.71 (18.0) × 1.38 (35.0)	For "18650" 0.71 (18.0) × 2.56 (65.0)
242 243 244	2.12 (53.8)	1.50 (38.1)	1.19 (30.2)	2.12 (53.8)	1.52 (38.6)	2.70 (68.6)

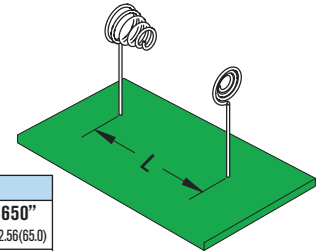

Refer to page 22 for Part Details

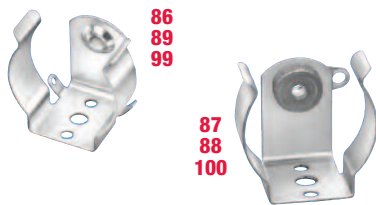

CAT. NO.	"L" DIMENSION		
	For "AA" 0.56 (14.2) × 1.98 (50.3)	For "C" 1.00 (25.4) × 1.97 (50.0)	For "D" 1.30 (33.0) × 2.42 (61.5)
99	0.91 (23.0)	-	-
100	-	-	-
86	-	0.91 (23.0)	-
87	-	-	1.19 (30.2)
88	-	-	-
89	-	-	-

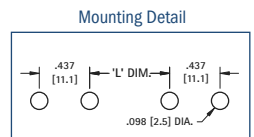

Refer to page 22 for Part Details



CAT. NO.	"L" DIMENSION		
	For "AA" 0.56 (14.2) × 1.98 (50.3)	For "C" 1.00 (25.4) × 1.97 (50.0)	For "D" 1.30 (33.0) × 2.42 (61.5)
206	1.10 (27.9)	-	-
207	-	0.81 (20.6)	-
208	-	-	1.25 (31.8)

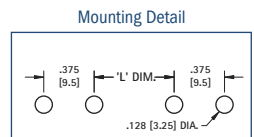

BATTERY LAYOUTS FOR MOLDED CASE CONTACTS

NOTE: ALL MOUNTING DIMENSIONS ARE FOR REFERENCE ONLY. VERIFY YOUR BATTERY LAYOUT PRIOR TO FABRICATION.

Refer to pages 20 & 21 for Part Details

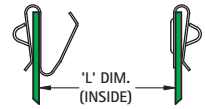
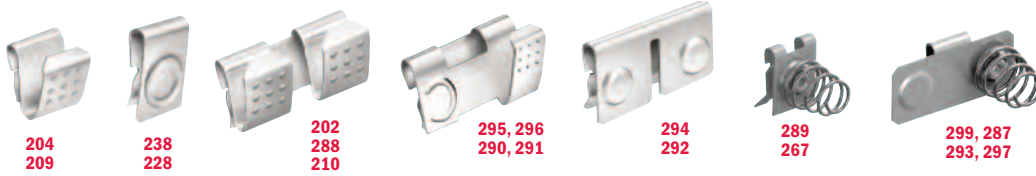

Fig. 1 Spring-Button

L dimensions reflect initial insertion deflection.

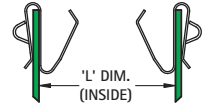

Fig. 2 Spring-Spring

L dimensions reflect initial insertion deflection.

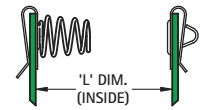

Fig. 3 Spring-Button

L dimensions reflect initial insertion deflection.

CAT. NO.	FIG. NO.	L DIMENSION					
		For "AAAA" 0.33 (8.4) × 1.67 (42.4)	For "A 27" 0.30 (7.7) × 1.10 (28.0)	For "A23" 0.39 (10.0) × 1.10 (28.0)	For "AAA" 0.41 (10.4) × 1.75 (44.5)	For "N" 0.45 (11.4) × 1.14 (29.0)	
204 with 238	1	1.79 (45.5)	1.22 (31.0)	1.22 (31.0)	1.87 (47.5)	1.26 (32.0)	
204,238 with 295, 296	1	N/A	N/A	N/A	1.87 (47.5)	N/A	
202 with 294	1	N/A	N/A	N/A	1.87 (47.5)	N/A	
204 with 204	2	1.89 (48.0)	1.32 (33.5)	1.32 (33.5)	1.97 (50.0)	1.36 (34.5)	
204 with 202	2	N/A	N/A	N/A	1.97 (50.0)	N/A	
267 with 238	3	1.86 (47.2)	1.29 (32.8)	1.29 (32.8)	1.94 (49.3)	1.33 (33.8)	
267, 238 with 299, 287	3	N/A	N/A	N/A	1.94 (49.3)	N/A	

CAT. NO.	FIG. NO.	L DIMENSION						
		For "AA" 0.56 (14.2) × 1.98 (50.3)	For "CR2" 0.60 (14.2) × 1.05 (26.7)	For "2/3 A" 0.67 (17.0) × 1.34 (34.5)	For "17500" 0.671 (17.0) × 1.97 (50.0)	For "18350" 0.71 (18.0) × 1.38 (35.0)	For "18650" 0.71 (18.0) × 2.56 (65.0)	
209 with 228	1	2.13 (54.1)	1.20 (30.5)	1.46 (37.1)	2.12 (53.8)	1.53 (38.8)	2.71 (68.8)	
209, 228 with 290, 291	1	2.13 (54.1)	N/A	N/A	N/A	N/A	N/A	
288, 210 with 292	1	2.13 (54.1)	N/A	N/A	N/A	N/A	N/A	
209 with 209	2	2.27 (57.7)	1.34 (34.0)	1.60 (40.6)	2.26 (57.4)	1.67 (42.3)	2.85 (72.3)	
209 with 288, 210	2	2.27 (57.7)	N/A	N/A	N/A	N/A	N/A	
289 with 228	3	2.24 (56.9)	1.31 (33.3)	1.62 (41.1)	2.23 (56.6)	1.64 (41.6)	2.82 (71.6)	
289, 228 with 293, 297	3	2.24 (56.9)	N/A	N/A	N/A	N/A	N/A	

*Built in circuit protection may increase length of battery, check battery specifications for exact battery length

Refer to pages 17 thru 19 for Part Details

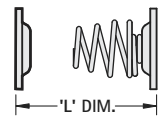

Fig. 4

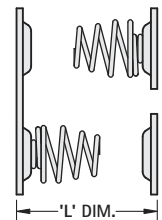

Fig. 5

CAT. NO.	FIG. NO.	"L" DIMENSION				
		For "AAAA" 0.33 (8.4) × 1.67 (42.4)	For "A27" 0.30 (7.6) × 1.10 (27.9)	For "A23" 0.40 (10.2) × 1.10 (27.9)	For "AAA" 0.41 (10.4) × 1.75 (44.5)	For "N" 0.45 (11.4) × 1.14 (29.0)
5203 with 5225	4	1.87 (47.5)	1.30 (33.0)	1.30 (33.0)	1.95 (49.5)	1.34 (34.0)
5204 with 5226	4	1.87 (47.5)	1.30 (33.0)	1.30 (33.0)	1.95 (49.5)	1.34 (34.0)
5214, 5213 with 5203, 5225	5	N/A	N/A	N/A	1.95 (49.5)	N/A

CAT. NO.	FIG. NO.	"L" DIMENSION						
		For "AA" 0.56 (14.2) × 1.98 (50.3)	For "CR2" 0.60 (15.2) × 1.05 (26.7)	For "2/3 A" 0.67 (17.0) × 1.36 (34.5)	For "17500" 0.67 (17.0) × 1.97 (50.0)	For "18350" 0.71 (18.0) × 1.38 (35.0)	For "18650" 0.71 (18.0) × 2.56 (65.0)	
5202 with 5224	4	2.23 (56.6)	1.30 (33.0)	1.61 (40.9)	2.22 (56.5)	1.63 (41.4)	2.81 (71.4)	
5222 with 5221	4	2.24 (56.9)	1.31 (33.3)	1.62 (41.1)	2.23 (56.6)	1.64 (41.7)	2.82 (71.6)	
5201 with 5223	4	2.24 (56.9)	1.31 (33.3)	1.62 (41.1)	2.23 (56.6)	1.64 (41.7)	2.82 (71.6)	
5220 with 5219	4	2.24 (56.9)	1.31 (33.3)	1.62 (41.1)	2.23 (56.6)	1.64 (41.7)	2.82 (71.6)	
5201, 5223 with 5210, 5211	5	2.24 (56.9)	N/A	N/A	N/A	N/A	N/A	
5222, 5221 with 5212	5	2.24 (56.9)	N/A	N/A	N/A	N/A	N/A	
5220, 5219 with 5217, 5218	5	2.24 (56.9)	N/A	N/A	N/A	N/A	N/A	
5227 with 5228	5	2.24 (56.9)	N/A	N/A	N/A	N/A	N/A	

CAT. NO.	FIG. NO.	"L" DIMENSION		
		For "C" 0.99 (25.0) × 1.97 (50.0)	For "26650" 1.02 (26.0) × 2.56 (65.0)	For "D" 1.30 (33.0) × 2.24 (56.9)
5240 with 5241	4	2.25 (57.2)	3.07 (78.0)	N/A
5250 with 5251	4	N/A	N/A	2.75 (69.9)
5240, 5241 with 5242	5	2.25 (57.2)	N/A	N/A
5250, 5251 with 5252, 5253	5	N/A	N/A	2.75 (69.9)

*Built in circuit protection may increase length of battery, check battery specifications for exact battery length