



Underwriters Laboratories, Inc.
Recognized Component Program –
UL File Number E354010



UL file number E354010 has been assigned to Keystone Electronics' fuse clips and holders with end stops. (Refer to pages 48-51) Indicating recognition by Underwriters Laboratories Inc. that they are in compliance with their component program.

Refer to pages 54-56 for Fuse Clip Layout and Mounting Details

- Available for 5mm, 1AG, 2AG, 3AG, 5AG, 7AG & 8AG sizes
- Low profile, space saving
- Low contact resistance
- Withstands shock and vibration
- Rated 6.3 to 30 Amps
- Custom designs and modifications available to your specifications

PC THRU MOUNT TYPES

- Snap-fit design enhances assembly and PC retention for wave soldering
- Available with orientation legs to assure proper PC installation
- Available with or without end stops

SURFACE MOUNT & RIVET TYPES

- KTR parts have Kapton Tape added to top service for vacuum pick & place

2AG, 5mm PC Clips

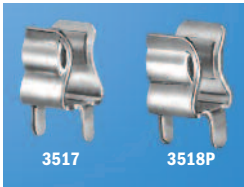

3517 3518P

MATERIAL:

.020 (.51) Brass, Tin Plate
UL Current Rating: 15 Amps

CAT. NO.	A	B
3517	.060 (1.5)	.060 (1.5)
3518P	.060 (1.5)	.093 (2.4)

With or Without Orientation Legs

Optional cover available - **Cat. No. 3517C**

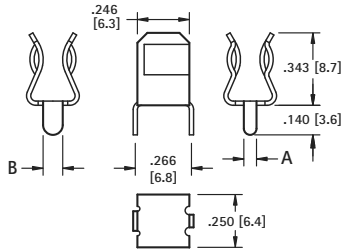

3512 3512P

MATERIAL:

.020 (.51) Brass, Tin Plate
UL Current Rating: 15 Amps

CAT. NO.	A	B
3512	.060 (1.5)	.060 (1.5)
3512P	.060 (1.5)	.093 (2.4)

With or Without Orientation Legs

Optional cover available - **Cat. No. 3517C**

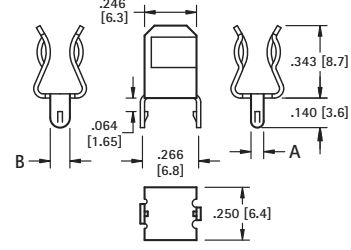

MATERIAL:

.016 (.41) Brass, Tin Plate
UL Current Rating: 6.3 Amps

CAT. NO. 3520

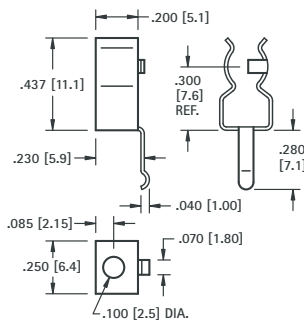

MATERIAL:

.016 (.41) Brass, Tin Plate
UL Current Rating: 15 Amps

CAT. NO. 3519

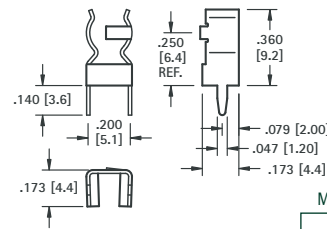

Mounting Detail

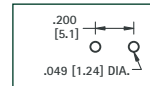

FUSE CLIPS



2AG or 5mm



3521 3561

MATERIAL: .016 (.41) Brass, Tin Plate
UL Current Rating: 15 Amps

CAT. NO.	ON TAPE BULK	ON TAPE & REEL	PC LEGS	END STOP
3521	—	—	YES	YES
3621	—	—	YES	NO*
3561	3561KTR	—	NO	YES
3622	3622KTR	—	NO	NO*

Mounting Detail
 Cat. No. 3521 & 3621 Only

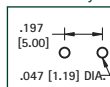
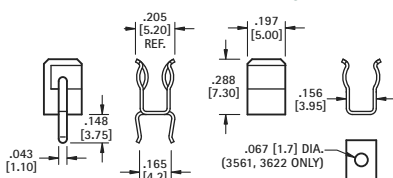

Table & Reel Spec's: 16m wide, 12mm pitch, 13 inch reel (500 pieces per reel)

THM SMT



5mm/3AG



MATERIAL:

.016 (.41) Brass, Tin Plate
UL Current Rating: 15 Amps

CAT. NO. 3562

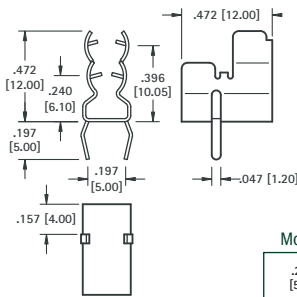

Mounting Detail

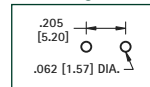

4AG (9/32 Dia.)



MATERIAL:

.020 (.51) Brass, Nickel Plate
UL Current Rating: 15 Amps

CAT. NO. 3565 (Without End Stops)*

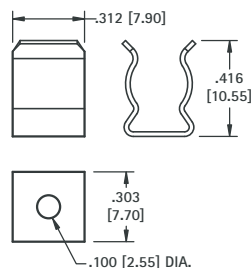

5AG (13/32 Dia.) - Solar Protection Fuse



MATERIAL:

.030 (.76) Brass, Tin Plate
UL Current Rating: 30 Amps

CAT. NO. 3566

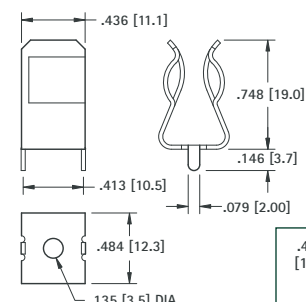

Mounting Detail

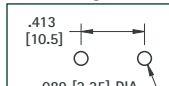

*Fuse clips without end stops are not UL recognized

Refer to pages 54-56 for Fuse Clip Layout and Mounting Details

1AG, 3AG, 7AG, 8AG THRU HOLE MOUNT TYPES

WITH SNAP-IN PC LEGS



MATERIAL:
.020 (.51) Brass, Tin Plate
UL Current Rating: 15 Amps

CAT. NO. 3513

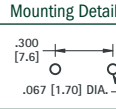
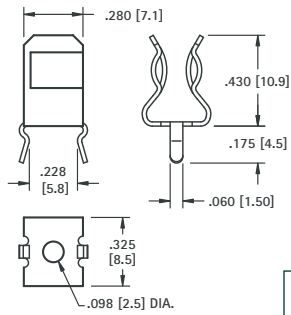

WITH SNAP-IN PC LEGS



MATERIAL:
.020 (.51) Brass, Tin Plate
UL Current Rating: 15 Amps

CAT. NO.	A	B
3515	.060 (1.5)	.060 (1.5)
3515P	.060 (1.5)	.093 (2.4)
3516P	.060 (1.5)	.120 (3.0)

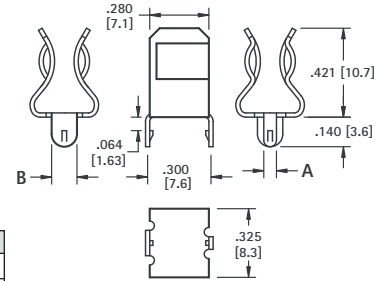

With or Without Orientation Legs

WITH STRAIGHT PC LEGS



MATERIAL:
.020 (.51) Brass, Tin Plate
UL Current Rating: 15 Amps

CAT. NO. 3530

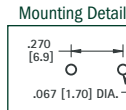
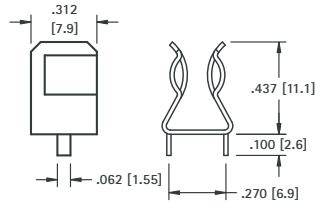

WITH STRAIGHT PC LEGS

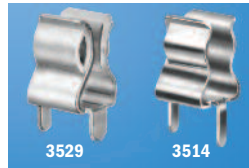

MATERIAL:
.020 (.51) Brass, Tin Plate
UL Current Rating: 15 Amps

CAT. NO.	H	L	END STOPS
3510	.421 (10.7)	.140 (3.6)	NO*
3529	.421 (10.7)	.140 (3.6)	YES
3511	.430 (10.9)	.250 (6.4)	NO*
3514	.430 (10.9)	.250 (6.4)	YES

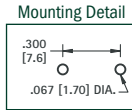
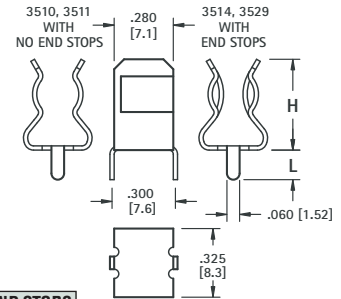

SNAP-IN WITH END STOP



MATERIAL:
.020 (.51) Brass, Nickel Plate
UL Current Rating: 20 Amps

CAT. NO. 3500

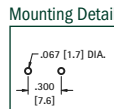
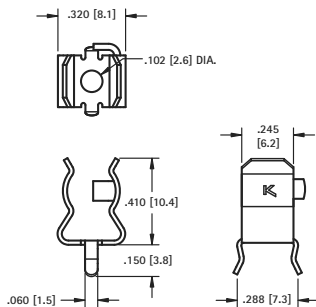

SMT & RIVET MOUNT, LOW PROFILE



MATERIAL:
.020 (.51) Brass, Nickel Plate
UL Current Rating: 15 Amps

CAT. NO. 3531 (Without End Stops)*

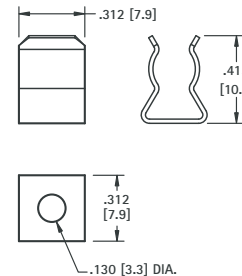

SMT & RIVET MOUNT WITH LUG



MATERIAL:
.020 (.51) Brass, Nickel Plate
Current Rating: 15 Amps

CAT. NO.	A	B
3533	Flat	.656 (16.7)
3535	45°	.562 (14.3)
3570	-	NO TAB

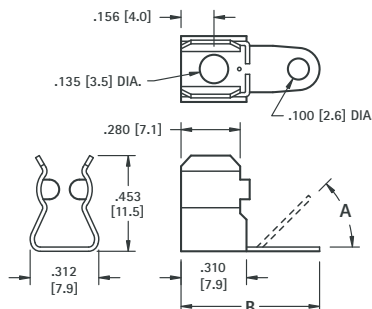

SMT & RIVET MOUNT

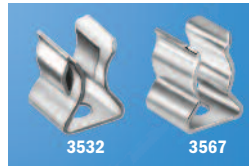

MATERIAL:
.020 (.51) Brass, Nickel Plate
UL Current Rating: 15 Amps

CAT. NO.	END STOPS
3532	YES
3567	NO*

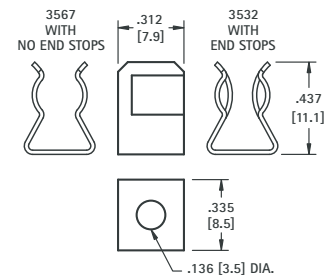

*Fuse clips without end stops are not UL recognized