

ACCEPTS ALL TABS
 .110 (2.8) TO .250 (6.4) x .020 (.50) TO .032 (.81)

VERTICAL OR HORIZONTAL ENTRY

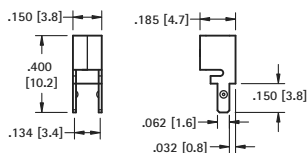

MATERIAL:
 .016 (.41) Brass, Tin-Nickel Plate

CAT. NO.	ORIENTATION
3557	top & side entry

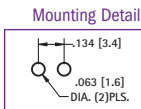

BOTTOM ENTRY

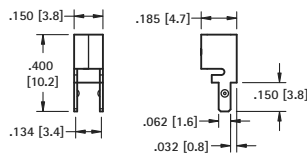

MATERIAL:
 .016 (.41) Brass, Tin-Nickel Plate

CAT. NO.	ORIENTATION
3577	bottom entry

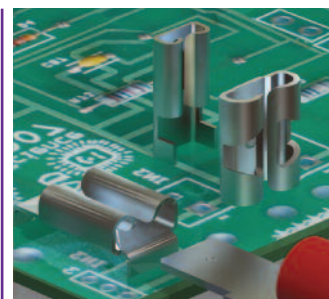
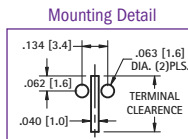

Underwriters Laboratories, Inc.
 Recognized Component Program
 — UL File Number E201546

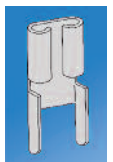

ACCEPTS .110 (2.8) TAB

VERTICAL ENTRY

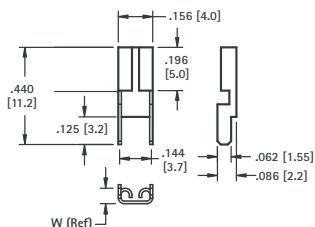

MATERIAL:
 .012 (.30) Brass, Tin-Nickel Plate

CAT. NO.	ACCEPTS TAB	W
3534	.110 (2.8) x .020 (.51)	.070 (1.80)
3544	.110 (2.8) x .032 (.81)	.075 (1.92)

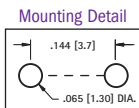

ACCEPTS .187 (4.8) TAB

VERTICAL ENTRY

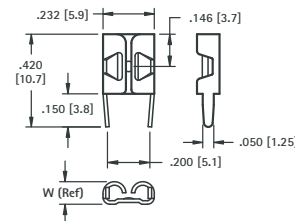

MATERIAL: .016 (.41) Brass, Tin-Nickel Plate

CAT. NO.	ACCEPTS TAB	"W"
3548	.187 (4.8) x .020 (.51)	.093 (2.36)
3578†	.187 (4.8) x .020 (.51)	.093 (2.36)
3551	.187 (4.8) x .032 (.81)	.102 (2.59)

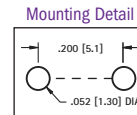

†Low insertion force design

ACCEPTS .205 (5.2) TAB

VERTICAL ENTRY

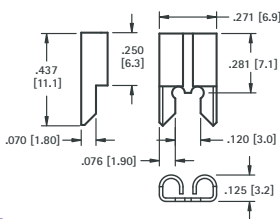

MATERIAL:
 .016 (.41) Brass, Tin-Nickel Plate

CAT. NO.	ACCEPTS TAB
3525	.205 (5.2) x .020 (.51)
3575*	.205 (5.2) x .032 (.81)

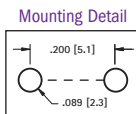

ACCEPTS .250 (6.4) TAB

VERTICAL ENTRY

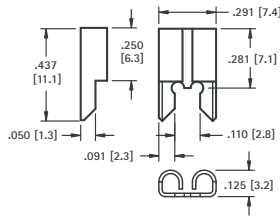

MATERIAL:
 .016 (.41) Brass, Tin-Nickel Plate

CAT. NO.	ACCEPTS TAB
3528	.250 (6.4) x .032 (.81)

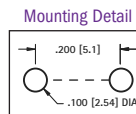

ACCEPTS .312 (7.9) TAB

OVER SIZED

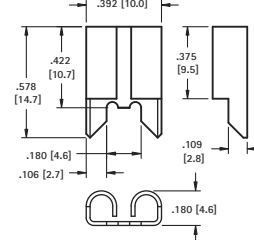

MATERIAL:
 .020 (.51) Copper, Tin-Nickel Plate

CAT. NO. 3555

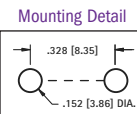

ACCEPTS .110 (2.8) TAB

HORIZONTAL ENTRY

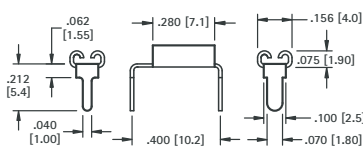

MATERIAL:
 .012 (.30) Brass, Tin-Nickel Plate

CAT. NO.	ACCEPTS TAB
3545	.110 (2.8) x .020 (.51)
3549	.110 (2.8) x .032 (.81)

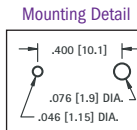

ACCEPTS .187 (4.8), .205 (5.2), .250 (6.4) TAB

HORIZONTAL ENTRY

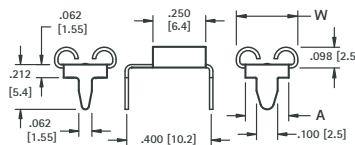

MATERIAL: Brass, Tin-Nickel Plate

CAT. NO.	ACCEPTS TAB	"W"	"A"	MATL THICK
3571	.187 (4.8) x .020 (.51)	.222 (5.6)	.162 (4.1)	.012 (.30)
3572*	.187 (4.8) x .032 (.81)			
3546	.205 (5.2) x .020 (.51)			
3550	.205 (5.2) x .032 (.81)	.240 (6.1)	.180 (4.6)	.012 (.30)
3547	.250 (6.4) x .032 (.81)	.291 (7.4)	.205 (5.2)	.016 (.41)

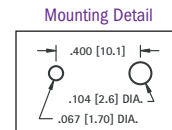

* Not UL Recognized

SMT QUICK-FIT FEMALE TERMINALS

AVAILABLE ON TAPE AND REEL



ACCEPTS ALL TABS
VERTICAL OR HORIZONTAL ENTRY

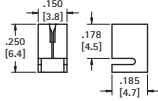

SPECIFICATIONS

Material: .016 (.41) Brass, Tin-Nickel Plate
Current Rating: 15 Amps @ 500V AC

CAT. NO. 3584 (Bulk)

CAT. NO. 3584KTR (Tape & Reel)

Tape & Reel Spec's: 16mm wide, 12mm pitch, 13 inch reel (750 pieces per reel)

ACCEPTS ALL TABS
VERTICAL OR HORIZONTAL ENTRY

KTR parts have Kapton Tape added to top surface for vacuum pick & place

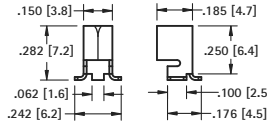

SPECIFICATIONS

Material: .016 (.41) Brass, Tin-Nickel Plate
Current Rating: 15 Amps @ 500V AC

CAT. NO. 3586 (Bulk)

CAT. NO. 3586KTR (Tape & Reel)

Tape & Reel Spec's: 16mm wide, 12mm pitch, 13 inch reel (750 pieces per reel)



ACCEPTS .110 (2.8) × .032 (.81) TAB
HORIZONTAL ENTRY

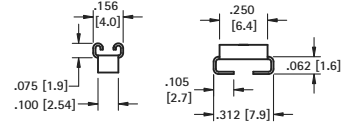

SPECIFICATIONS

Material: .012 (.30) Brass, Matte Tin Plate
Current Rating: 15 Amps @ 500V AC

CAT. NO. 3569 (Bulk)

CAT. NO. 3569TR (Tape & Reel)

Tape & Reel Spec's: 24mm wide, 8mm pitch, 13 inch reel (2000 pieces per reel)

SMT .110 (2.8) TAB EDGE CONNECTOR

AVAILABLE ON TAPE AND REEL

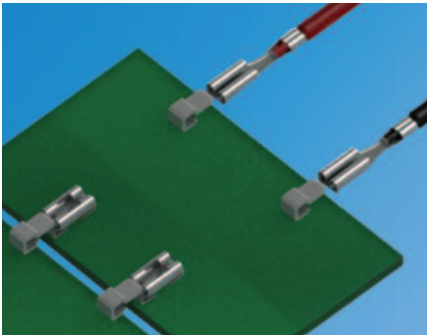

CAT. NO. 3579 Bulk

CAT. NO. 3579TR (Tape & Reel)

Tape & Reel Spec's: 24mm wide, 8mm pitch, 13 inch reel (1000 pieces per reel)

- Designed to pass signals or voltage across boards
- Generous lead-in guide aid in board assembly
- Designed to be used with **Cat. No. 3569**
- .110 tab design also allows standard crimp terminals to be used, see page 70
- Compatible with most automated assembly processes

SPECIFICATIONS

Material: Brass, Tin Plate
Current Rating: 10 Amps
Operating Temperature: -40°F to +257°F (-40°C to 125°C)
Life: 100 cycles

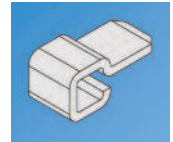
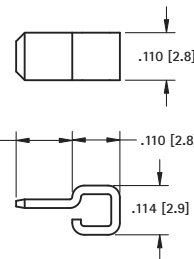
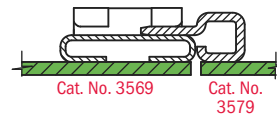

Pad Layout

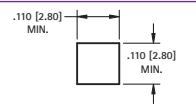

SMT LOW PROFILE EDGE CONNECTORS

AVAILABLE ON TAPE AND REEL

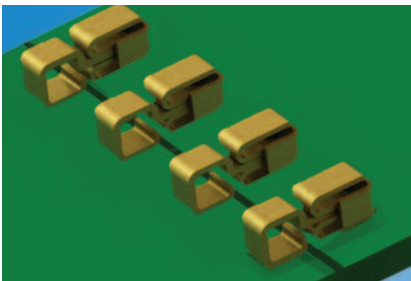

- Designed to pass signals or power across boards
- Generous lead-in guide aid in board assembly
- Gold plating provides superior solderability as well as low contact resistance
- Compatible with most automated assembly processes

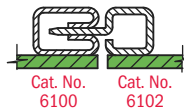

SPECIFICATIONS

Material: Phosphor Bronze, Gold Plate
Current Rating: 10 Amps
Operating Temperature: -40°F to +257°F (-40°C to 125°C)
Life: 100 cycles

SMT EDGE PIN

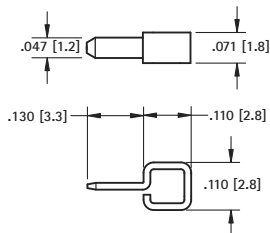

CAT. NO. 6100 Bulk

CAT. NO. 6100TR (Tape & Reel)

Tape & Reel Spec's: 16mm wide, 8mm pitch, 7 inch reel (500 pieces per reel)

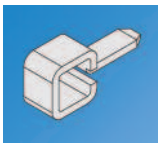

Pad Layout

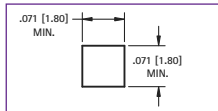

SMT EDGE SOCKET

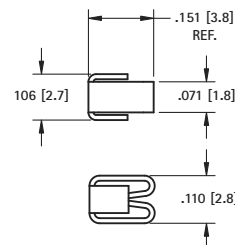

CAT. NO. 6102 Bulk

CAT. NO. 6102TR (Tape & Reel)

Tape & Reel Spec's: 12mm wide, 4mm pitch, 7 inch reel (500 pieces per reel)



Pad Layout

